

A : Power Pin Assignment	
Signal	AMP-172167-1
U	3
V	2
W	1
≡	4

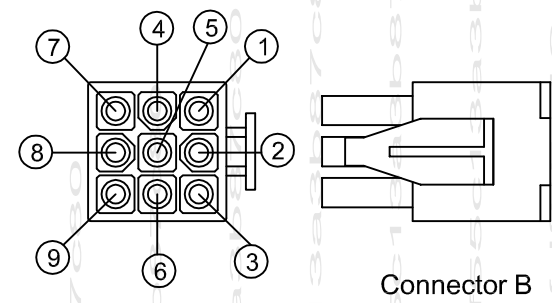

B : Encoder Pin Assignment		
Function	Signal	AMP 1-172169-9
Power	5V	1
	0V	2
Serial data	SD +	7
	SD -	8
Shielding	Shielding	9
Battery	VB	5
	GND	6

Rated Power : 200W
Drive Input Voltage : 220VAC
Rated Torque : 0.64N-m
Rated Speed : 3000 rpm
Rated Current : 1.6A(Arms)
Moment of Inertia : 0.26 Kg-m² (*10⁻⁴)
Encoder : 23-bit Absolute
Brake : No
Shaft : Key, Center tap
Oil seal : Yes

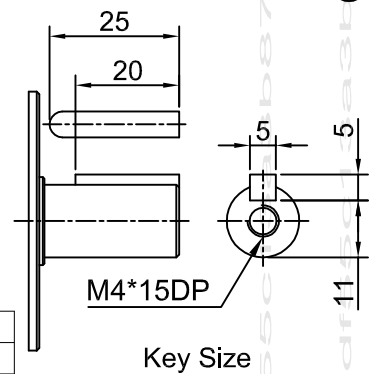

ITEM	DATE	MODIFIED	DESCRIPTION	ECN NO.	CHK	APPD

NAME	DWG NO	SHEET	TYPE	EM1-C-M-20-2-0-F-0-D	DATE	2019.09.23
AC SERVO MOTOR	AC42407	A1	1-1	CUSTOMER	DRN	周孟儒
HIWIN® MIKROSYSTEM CORP.			SCALE	1 : X	CHK	何昆懋
			PART NO	FRE02202F004	APPD	黎振安