

Torque(N-m)

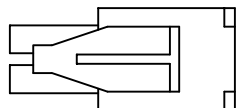

Connector A

Power Pin Assignment	
Signal	AMP-172167-1
U	3
V	2
W	1
≡	4

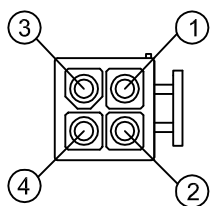
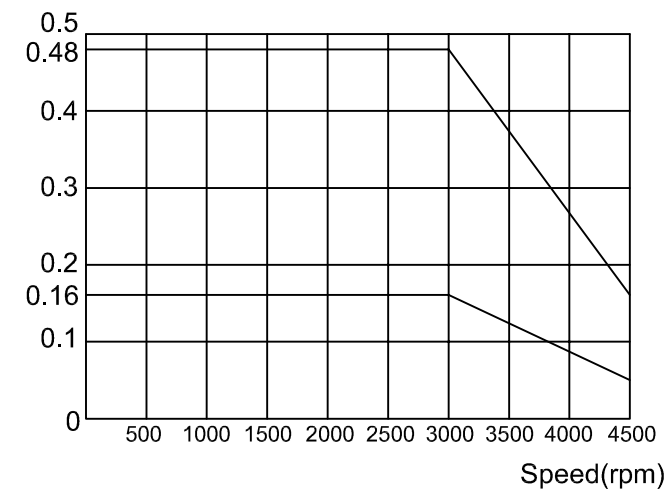
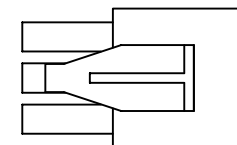
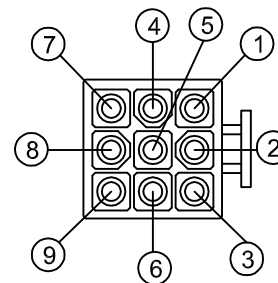

Connector B

B : Encoder Pin Assignment		
Function	Signal	AMP 1-172169-9
Power	5V	1
	0V	2
Incremental Signal	SL +	3
	SL -	4
	TBD --	5
	TBD --	6
	MA +	7
	MA -	8
Shielding	Shielding	9

Rate Power : 50W
 Driver Input Voltage : 220V
 Rated Torque : 0.16N-m
 Rated Speed : 3000 rpm
 Rated Current : 0.9A(Arms)
 Moment of Inertia : 0.02 Kg-m² (*10⁻⁴)
 Allowable Load Inertia Ratio : 10 times or less
 Encoder : 17-bit Incremental
 Brake : No
 Shaft : Key, Center tap
 Oil seal : Yes

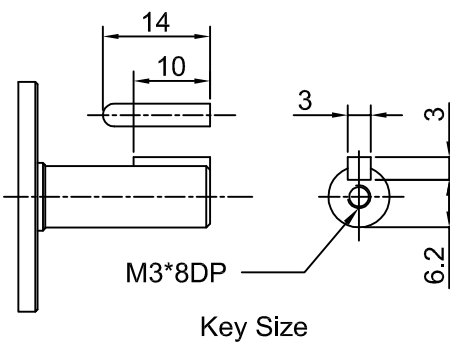

Key Size

NAME	DWG NO	SHEET	TYPE	LS50W	DATE	2017.10.20
AC SERVO MOTOR	AC02114 A1	1-1	CUSTOMER		DRN	林政穎
HIWIN ® MIKROSYSTEM CORP.				SCALE	1 : X	CHK 黎振安
				PART NO	FRLS05206A4D	APPD 鄭立巍

ITEM	DATE	MODIFIED	DESCRIPTION	APPD