

EQI型磁粉心

EQI Cores

EQI形磁粉心命名 EQI - Core Identification

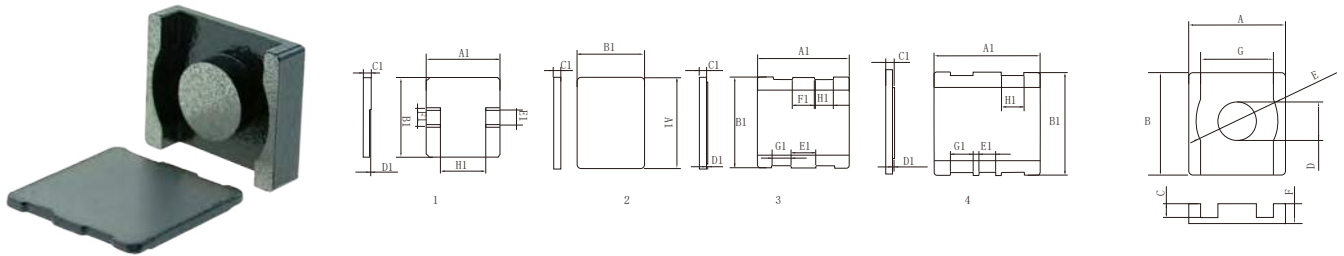

型号Type	E 尺寸 (Dimensions of E core)							I 尺寸 (Dimensions of I core)				图示example
	A	B	C	D	E	F	G	A1	B1	C1		
EQI161510	16.3±0.2	15.0±0.2	6.8±0.2	7.3±0.2	14.5±0.2	4.0±0.3	6.90min	16.3±0.2	15.0±0.2	2.7±0.2	1	
EQI201408	20.5±0.3	14.0±0.2	5.1±0.2	8.8±0.2	18.0±0.3	2.7±0.3	12.8min	20.5±0.3	14.0±0.2	2.4±0.2	2	
EQI201412	20.5±0.3	14.0±0.2	9.6±0.2	8.8±0.2	18.0±0.3	7.2±0.3	12.8min	20.5±0.3	14.0±0.2	2.4±0.2	2	
EQI292510	29.3±0.4	25.0±0.3	7.4±0.2	14.0±0.2	26.3±0.4	5.0±0.3	20.6min	29.0±0.4	28.4±0.4	2.3±0.2	3	
EQI383510	37.5±0.5	35.0±0.5	8.0±0.2	15.3±0.2	32.4±0.5	5.7±0.3	28.0min	37.5±0.5	36.9±0.5	2.3±0.2	4	

EQI形磁粉心电感因数及有效参数 AL Value & Effective Parameters of EQI-Cores

型号Type	Le (mm)	Ae (mm ²)	Ve (mm ³)	AL (nH/N ²)		
				26	40	60
EQI161510	26.16	41.85	1639	53	80	121
EQI201408	28.68	60.82	1867	69	107	160
EQI201412	37.65	60.82	2417	53	81	122
EQI292510	41.57	153.94	5322	121	186	279
EQI383510	49.2	183.85	8540	122	188	282