

轨道型磁粉心 Square Round Shape Cores

轨道型磁粉心命名 Square Round Shape Core Identification

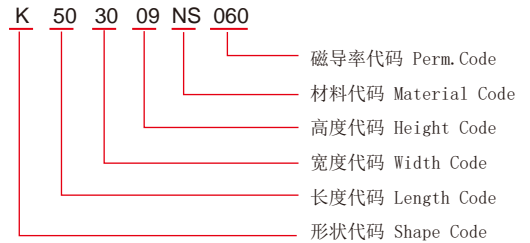
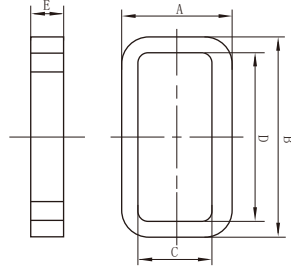

型号Type	尺寸 Dimension (mm)				
	A	B	C	D	E
K503009	30.0±0.3	50.0±0.3	20.0±0.3	42.0±0.3	9.0±0.3

UI型磁粉心命名 UI-Core Identification

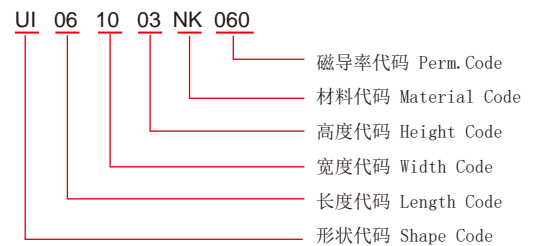
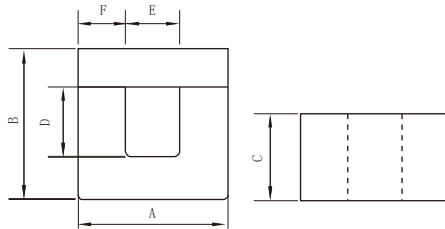

型号Type	尺寸 Dimension (mm)								
	U						I		
	A	B	C	D	E	F	A	B	C
UI061006	5.7±0.2	3.4±0.2	10.4±0.2	1.2±0.2	2.6±0.2	1.55±0.2	5.7±0.2	12.7±0.2	2.2±0.2
UI232313	23.0±0.3	8.6±0.2	22.7±0.2	4.4±0.2	14.35±0.2	4.2±0.2	23±0.2	22.7±0.2	4.2±0.2

UY型磁粉心命名 UY-Core Identification

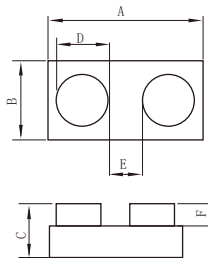
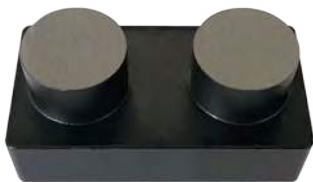

型号Type	尺寸 Dimension (mm)					
	A	B	C	D	E	F
UY603125	60.0±0.7	31.3±0.4	25.0±0.4	20.3±0.3	12.9±0.3	10.5±0.3

UY型磁粉心电感因数及有效参数 AL Value & Effective Parameters of UY-Cores

型号Type	Le (mm)	Ae (mm ²)	Ve (mm ³)	AL (nH/N ²)		
				26	40	60
UY603125	120.7	368.5	44478	100	153	230