

铁氧体磁心 Ferrite Cores

UU型磁心 UU Cores

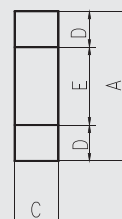
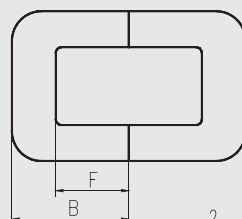
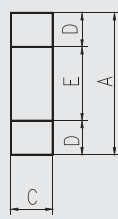
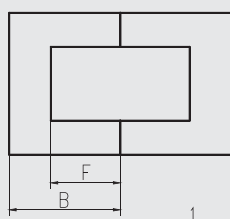
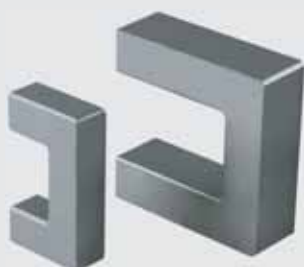

型号 Type		UU9.8/7/3	UU10.5/8/5	UU16/10/6	UU25.4/16/6	UU25/16/12.7
图号 Fig		1	1	1	1	1
尺寸 Dimensions(mm)	A	9.8±0.3	10.5±0.3	16.0±0.4	25.5±0.3	25.4±0.5
	B	7.1±0.2	7.9±0.2	10.0±0.2	16.25±0.25	16.0±0.15
	C	2.7±0.2	5.0±0.3	6.0±0.2	6.25 ^{+0.1} _{-0.4}	12.7±0.3
	D	2.8Ref	2.5Ref	4.57Ref	6.45Ref	6.45Ref
	E	4.1min	5.2min	6.7min	12.5min	12.4min
	F	4.25±0.20	5.25±0.20	6.0±0.15	10.6 ^{+0.3}	9.7±0.3
磁心参数 Core parameters	C1(mm ⁻¹)	4.500	3.200	1.970	2.340	1.040
	le(mm)	34.2	40.1	51.0	87.2	84.2
	Ae(mm ²)	7.60	12.5	25.9	37.3	81.1
	Ve(mm ³)	262	501	1320	3250	6830
	重量Weight(g/pr)	1.3	2.5	6.9	25	38
电感因数 AL	HP2	1180	1550	2780	2500	5000
	LP3			1100	1020	2290
	LP3A			1100	1020	2290
	LP9			1450	1230	2770

型号 Type		UU26/14/10	UU30/13/6	UU33/14/7	UU35/14/10
图号 Fig		1	1	1	2
尺寸 Dimensions(mm)	A	26.0±0.4	30.0±0.5	33.0±0.5	35.0±0.6
	B	14.0±0.2	12.7±0.15	13.8±0.15	14.0±0.2
	C	10.0±0.3	6.25±0.15	7.25±0.2	10.0±0.3
	D	6.0±0.3	6.25Ref	7.3Ref	5.0±0.25
	E	14.0Ref	17.3min	18.0min	25.0±0.25
	F	9.0±0.2	6.2 ^{+0.3}	6.2 ^{+0.25}	9.0±0.3
磁心参数 Core parameters	C1(mm ⁻¹)	1.470	2.050	1.590	2.030
	le(mm)	80.8	80.4	85.7	102
	Ae(mm ²)	54.8	39.1	53.7	50.0
	Ve(mm ³)	4420	3140	4600	5090
	重量Weight(g/pr)	23	17	25	26
电感因数 AL	HP2	3800	2800	3000	3150
	LP3	1620	1160	1500	1170
	LP3A	1620	1160	1500	1170
	LP9	1950	1400	1810	1420

注：电感因数AL value

单位Unit:nH/N²

测试条件Measuring conditions:10kHz,0.1V,25

公差Tolerance: ± 25%

铁氧体磁心

Ferrite Cores

UU型磁心 UU Cores

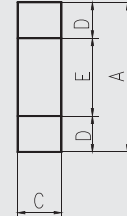
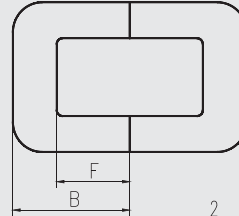
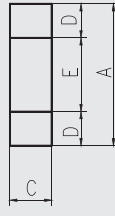
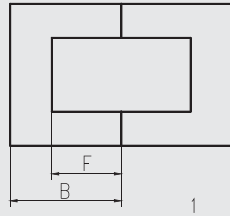

型号 Type		UU38/21/10	UU65/64/40	UU66/55/40	UU73/34/28	UU80/65/30
图号 Fig		1	1	1	1	2
尺寸 Dimensions(mm)	A	37.5±0.5	65.0±1.5	66.0±1.5	72.8±1.5	80.0 ^{+2.0} _{-1.0}
	B	21.25 ^{+0.25}	63.5±1.0	55.0±1.0	33.7±1.0	65.0±0.5
	C	9.6±0.4	40.0±0.5	39.6±0.6	27.9±0.5	30.0±0.5
	D	4.75Ref	20.0±0.5	19.5±0.5	13.8±0.5	21.5±0.5
	E	27.5min	24.4min	25.0min	45.0min	37.0Ref
	F	16.63 ^{+0.25}	43.0±0.7	36.5±1.0	19.7±0.7	43.0±1.0
磁心参数 Core parameters	C1(mm ⁻¹)	2.960	0.354	0.342	0.548	0.485
	le(mm)	138	286	260	212	314
	Ae(mm ²)	46.4	806	759	387	647
	Ve(mm ³)	6380	230000	197000	82000	203000
	重量Weight(g/pr)	31	1170	960	410	1217
电感因数 AL	HP2	1300				
	LP3	900	6400	6000	4400	4800
	LP3A	900	6400	6000	4400	4800
	LP9	980	7800	8100	5100	5700

型号 Type		UU80/85/40	UU82/45/14	UU93/76/30	UU93/79/28
图号 Fig		1	1	1	1
尺寸 Dimensions(mm)	A	80.0 ^{+3.0} _{-2.0}	80.0 ^{+3.0} _{-2.0}	93.0±2.0	93.0±2.0
	B	85.0±1.0	45.0±0.8	76.0±0.5	79.0±1.0
	C	40.0±1.0	14.0±0.5	30.0±0.5	28.0±1.0
	D	20.0±0.5	13.9Ref	28Ref	28.0±0.5
	E	40.0min	53.0min	34.6min	34.6min
	F	65.0±1.0	31.0±0.8	48.0±0.9	49.5±1.0
磁心参数 Core parameters	C1(mm ⁻¹)	0.543	1.370	0.408	0.454
	le(mm)	435	275	355	362
	Ae(mm ²)	801	200	869	797
	Ve(mm ³)	34800	54900	308000	289000
	重量Weight(g/pr)	1560	265	1490	1450
电感因数 AL	HP2				
	LP3	4400	1900	5500	5000
	LP3A	4400	1900	5500	5000
	LP9	5100	2200	6800	6100

注：电感因数AL value

单位Unit:nH/N²

测试条件Measuring conditions:10kHz,0.1V,25

公差Tolerance: ± 25%

铁氧体磁心 Ferrite Cores

UU型磁心 UU Cores

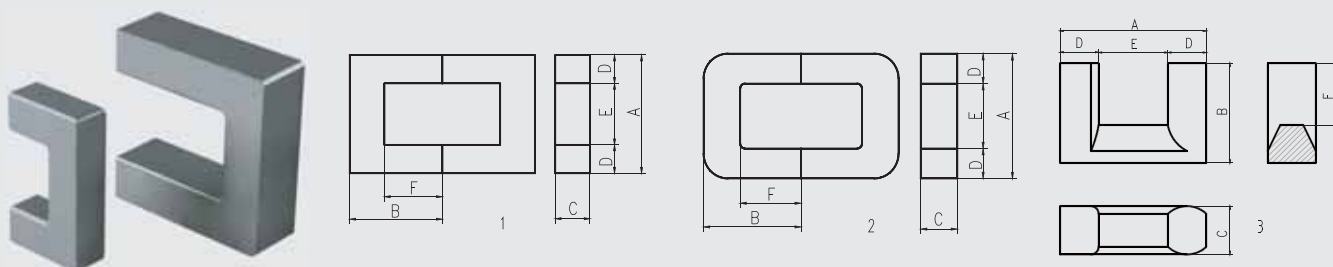

型号 Type		UU95/85/40	UU96/79/30	UU100/57/25	UU100/75/30	U105/95/40
图号 Fig		1	1	1	1	1
尺寸 Dimensions(mm)	A	95.0 ^{+3.0} _{-2.0}	96.0±2.0	101.6±2.5	100.0±3.0	105.0±2.5
	B	85.0±1.0	79.0±0.5	57.1±0.4	75.5±1.0	95.0±0.5
	C	40.0±1.0	30.0±0.5	25.4±0.8	30.0±1.0	40.0±1.0
	D	20.0Ref	30.0±0.5	25.4±0.8	30.0±1.0	30.0±1.0
	E	54.5min	34.0min	50.8±2.0	37.5min	45.0Ref
	F	65.0±0.5	49.0±0.5	31.7±0.75	45.0±0.75	65.0 ^{+1.5} ₀
磁心参数 Core parameters	C1(mm ⁻¹)	0.540	0.402	0.477	0.386	0.376
	le(mm)	430	360	308	354	443
	Ae(mm ²)	796	894	645	917	1179
	Ve(mm ³)	343000	322000	199000	324600	522500
	重量Weight(g/pr)	1660	1610	995	1620	2765
电感因数 AL	HP2					
	LP3	4600	5500	5000	6500	6300
	LP3A	4600	5500	5000	6500	6300
	LP9	5100	6900	5800		

型号 Type		UU110/95/40	UU114/78/38	UU120/70/30	UU120/80/40
图号 Fig		1	3	1	1
尺寸 Dimensions(mm)	A	110.0±2.5	114.0±2.5	120.0±2.0	120.0±3.0
	B	95.0±1.0	77.5±1.0	70.0±0.5	80.0±1.0
	C	40.0±1.0	37.5±1.0	30.0±1.0	40.0±1.5
	D	30.0±1.0	30.0±0.5	29.8±0.8	30.0±0.5
	E	50.0±1.5	54.0±1.5	59.5min	59.0min
	F	65.0±1.0	48.0±1.0	40.0±1.0	50.5±1.0
磁心参数 Core parameters	C1(mm ⁻¹)	0.380	0.352	0.416	0.349
	le(mm)	448	387	374	421
	Ae(mm ²)	1180	1100	900	1200
	Ve(mm ³)	529700	426000	33700	505000
	重量Weight(g/pr)	2655	2160	1700	2600
电感因数 AL	HP2				
	LP3	6900	6900	5700	6900
	LP3A	6900	6900	5700	6900
	LP9				

注：电感因数AL value

单位Unit:nH/N²

测试条件Measuring conditions:10kHz,0.1V,25

公差Tolerance: ± 25%

铁氧体磁心

Ferrite Cores

UU型磁心 UU Cores

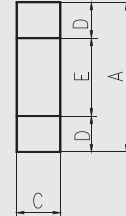
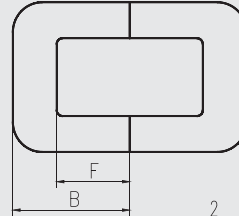
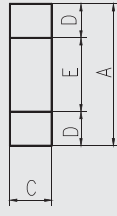
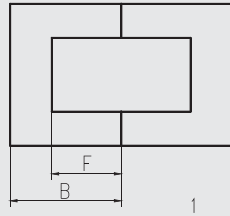

型号 Type		UU120/118/40	UU126/91/25	UU140/95/39	UU160/120/40	UU160/125/20
图号 Fig		1	2	1	1	1
尺寸 Dimensions(mm)	A	120.0±3.0	126.0±3.0	140.0 ^{+5.0} _{-2.0}	161.0±3.0	162.0±3.0
	B	117.5±1.0	90.0±1.0	95.0 ^{+2.0}	120.0±1.0	125.0±0.5
	C	40.0±1.5	25.0±0.8	39.0±1.5	40.0±1.0	20.0±1.0
	D	30.0±0.5	28.0Ref	40.0±1.0	40.0±1.0	50.5±0.5
	E	59.0min	70.0±2.0	60.0min	78.0min	60.0min
	F	87.5±1.5	63.0±2.0	56.5 ^{+1.2}	80.0±1.5	75.0±1.5
磁心参数 Core parameters	C1(mm ⁻¹)	0.470	0.692	0.321	0.378	0.574
	le(mm)	564	480	497	597	578
	Ae(mm ²)	1200	693	1548	1577	1007
	Ve(mm ³)	677000	333000	741500	941700	582000
	重量Weight(g/pr)	3295	1575	3500	4710	2960
电感因数 AL	HP2					
	LP3	4800	3500	7000	5800	3900
	LP3A	4800	3500	7000	5800	3900
	LP9					

注：电感因数AL value

单位Unit:nH/N²

测试条件Measuring conditions:10kHz,0.1V,25

公差Tolerance: ± 25%