

# RDL 50-7/8RM – High Fire Resistant LSOH Jacket M5634Z

## Description

Inner Conductor:	Copper tube	9.3 mm
Dielectric:	Foam Polyethylene	22.5 mm
Fire barrier:	Mica tape	
Outer Conductor:	Overlapping copper foil with slots	
Jacket:	High Fire resistant Low smoke Zero Halogen Compound	27.0 mm
Ink Marking:	<b>ACOME RADIACELL COAX LSOH RDL 50-7/8RM M5634 LOT X lot N° (+ Metric length)</b>	

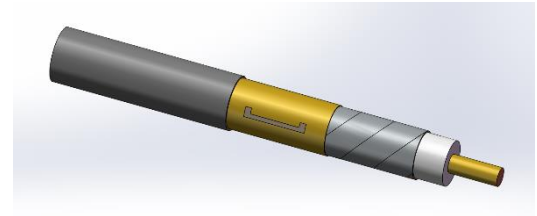

## Electrical Characteristics

Impedance:	50 ± 2Ω					
VSWR:	694~960MHz	≤ 1.38	Frequency (MHz)	Attenuation (dB/100m) @ 20°C Typical	Coupling Loss (50%) @20°C dB,	Coupling Loss (95%) @20°C dB
	1770~1900MHz	≤ 1.38	700	3.80	85	88
	1920~2025MHz	≤ 1.38	800	4.42	76	81
	2110~2200 MHz	≤ 1.38	900	4.80	75	75
	2300~2550 MHz	≤ 1.38	1800	8.34	71	73
	2560~2620 MHz	≤ 1.38	2000	9.42	71	73
Cut Off Frequency:	5 GHz		2200	10.42	70	70
Velocity:	Typical	88%	2400	11.78	70	70
DC Breakdown Voltage:	10 kV		2600	13.50	70	70
Insulation Resistance:	>5000 MΩ.km					

## Mechanical Characteristics

Minimum bending radius	300mm
Tensile Force:	2300N
Weight:	456 kg/km

## Environmental Characteristics

Temperature Range:	Operating	-30°C / +80°C
	Installation	-25°C / +60°C
	Storage	-30°C / +80°C
pH:	IEC 60754-2	≥4.3
Conductivity:	IEC 60754-2	≤10 μs/mm
Acid gas emission test:	IEC 60754-1	≤5.0 mg/g
Smoking density test (Min. photic rate)	IEC 61034-2	≥60%
Flame retardant:	IEC 60332-1, IEC 60332-3-24	
CPR:	B2ca for Preliminary	