

## RDL 50-1-5/8RM – High Fire resistant LSOH Jacket M5680Z

### Description

Inner Conductor:	Copper tube	17.3 mm
Insulation:	Physically foamed PE	43.5 mm
Fire barrier:	Mica tape	
Outer Conductor:	Overlapping copper foil with slots	
Jacket:	Low smoke zero halogen compound	47.5 mm
Ink Marking:	<b>ACOME RADIACELL COAX LSOH RDL 50-1-5/8RM M5680 LOT X lot N° (+ Metric length)</b>	

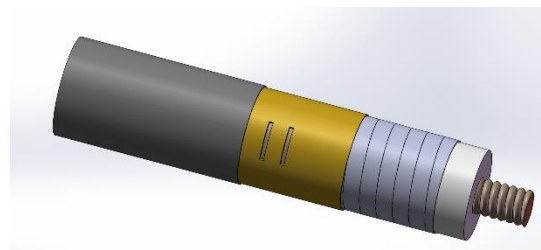

### Electrical Characteristics

Impedance:		50 ± 2 Ω
	380~450MHz	≤ 1.38
VSWR:	698~769MHz	≤ 1.38
	806~960MHz	≤ 1.38
Capacitance:		76 pF/m
Velocity:	Typical	88%
Cut Off Frequency:		2.75GHz
DC Breakdown Voltage:		10 kV
Insulation Resistance:		≥5000 MΩ.km

Frequency (MHz)	Attenuation (dB/km) @ 20 °C Max.	Coupling Loss (50%) @ 20 °C dB	Coupling Loss(95%) @ 20 °C dB
100	63	64	68
150	79	70	75
400	143	63	64
450	150	70	71
470	160	70	71
900	242	68	69

### Mechanical Characteristics

Bending Radius:	700 mm
Tensile force:	1700 N
Weight:	907kg/km

### Environmental Characteristics

Temperature Range:	Operating	-30 °C / +80 °C
	Installation	-25 °C / +60 °C
	Storage	-30 °C / +80 °C
pH:	IEC 60754-2	≥4.3
Conductivity:	IEC 60754-2	≤10 μ s/mm
Acid gas emission test:	IEC 60754-1	≤5.0 mg/g
Smoking density test (Min. photic rate)	IEC 61034-2	≥60%
Flame retardant:	IEC 60332-1, IEC 60332-3-24	
CPR:	B2ca for Preliminary	