

## RDL 50-1-5/8RM – High Fire Resistant LSOH Jacket M5755Z

### Description

<b>Inner Conductor:</b>	Helically corrugated copper tube	17.3 mm
<b>Insulation:</b>	Physically foamed PE	43.5 mm
<b>Fire barrier:</b>	Mica tape	
<b>Outer Conductor:</b>	Overlapping copper foil with slots	
<b>Jacket:</b>	High Fire resistant Low Smoke Zero Halogen Compound	48.0 mm
<b>Ink Marking:</b>	<b>ACOME RADIACELL COAX LSOH RDL 50-1-5/8RM M5755 LOT X lot N° (+ Metric length)</b>	

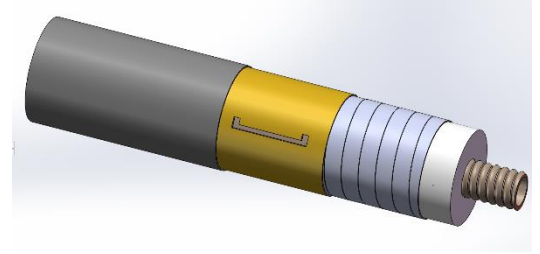

### Electrical Characteristics

<b>Impedance:</b>		50 ± 2Ω
<b>VSWR:</b>	694~960MHz	≤ 1.38
	1700~1900MHz	≤ 1.38
	1920~2025MHz	≤ 1.38
	2110~2200MHz	≤ 1.38
	2300~2500MHz	≤ 1.38
<b>Capacitance:</b>		76 PF/m
	<b>Velocity:</b>	Typical
<b>Cut Off Frequency:</b>		2.75GHZ
<b>DC Breakdown Voltage:</b>		15 kV
<b>Insulation Resistance:</b>		≥5000 MΩ.km

Frequency (MHz)	Attenuation (dB/100m) @ 20°C Typical	Coupling Loss (50%) @ 20°C dB	Coupling Loss (95%) @ 20°C dB
700	2.05	76	82
800	2.27	70	73
900	2.48	65	68
1800	3.78	62	65
1900	3.89	62	66
2100	4.43	60	64
2200	4.54	61	65
2600	5.62	57	60
2700	5.94	56	61

### Mechanical Characteristics

<b>Bending Radius:</b>	700 mm
<b>Tensile force:</b>	1700N
<b>Weight:</b>	907 kg/km

### Environmental Characteristics

<b>Temperature Range:</b>	Operating	-30°C / +80°C
	Installation	-20°C / +60°C
	Storage	-30°C / +80°C
<b>pH:</b>	IEC 60754-2	≥4.3
<b>Conductivity:</b>	IEC 60754-2	≤10 μs/mm
<b>Acid gas emission test:</b>	IEC 60754-1	≤5.0 mg/g
<b>Smoking density test (Min. photic rate)</b>	IEC 61034-2	≥60%
<b>Flame retardant:</b>	IEC 60332-1, IEC 60332-3-24	
<b>CPR:</b>	B2ca for Preliminary	