

用户手册 MANUAL

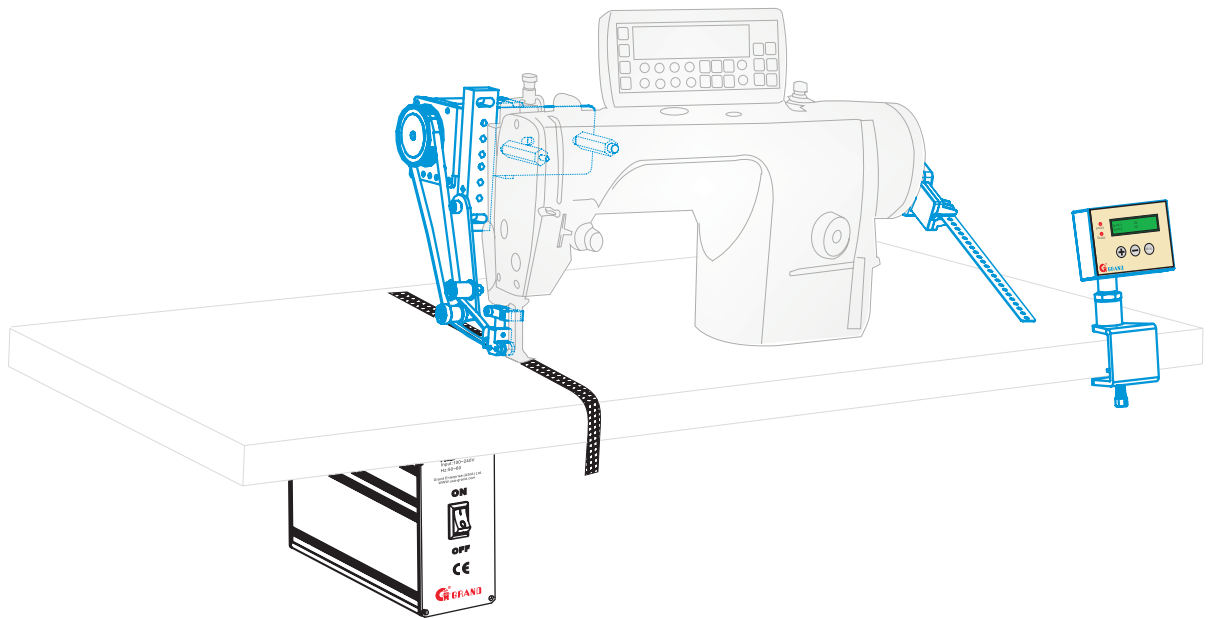

— **GRAND PULLER ATTACHMENT WITH TOP DRIVE BELT** —

MODEL **GBP-1**
拖轮皮带装置
THE TUG BELT DRIVE

GBP-3
上下拖轮装置
UP WITH DOWN OF TUG DRIVE

CONTENT

目 录

1. Control panel instruction	1
控制面版说明	
2. Control panel operation notes	2
控制面版使用说明	
3. Power supply box instruction	3
电源控制盒说明	
4. Assemble method	4-5
安装示意图	
5. Control box assembly drawing and list	6
控制盒装配图及清单	
6. GBP-1 stepper motor drive assembly drawing	7
GBP-1步进电机传动装配图	
7. GBP-1 parts list for stepper motor drive system	8
GBP-1步进电机传动清单	
8. GBP-3 stepper motor drive assembly drawing	9-10
GBP-3步进电机传动装配图	
9. GBP-3 parts list for stepper motor drive system	11
GBP-3步进电机传动清单	
10. Photoelectric sensor assembly drawing and list	12
光电传感器装配图及清单	
11. Controller assembly drawing and list	13
控制器装配图及清单	
12. GBP-3 Foot switch and pressure components	14
GBP-2脚踏开关与气压部件	

PULLER ATTACHMENT AFTER SEND DEVICE SERIES

拖轮皮带后送装置系列

Puller attachment with top drive

Tug drive

GPB-1L人字车拖轮皮带装置

GPB-1C绷缝机拖轮皮带装置

GPB-1O包缝机拖轮皮带装置

GPB-3C绷缝机上下拖轮装置



1. CONTROL PANEL INSTRUCTION

控制面板说明

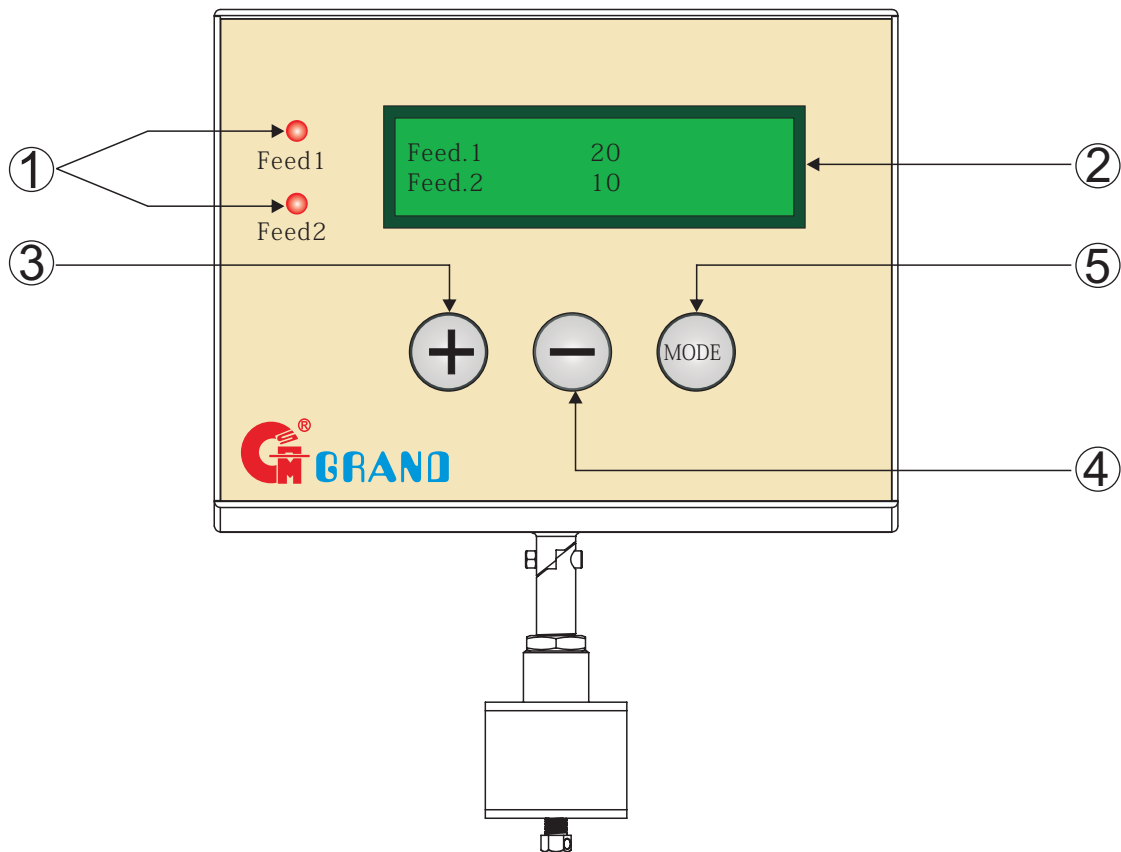

- ① Be illuminated at the selected program.
指示选择项目
- ② Displaying the belt feeding volume.
显示送带数据
- ③ Push to increase the belt feeding volume. (Maximum: 25)
增加速度
- ④ Push to reduce the belt feeding volume. (Minimum: 1)
降低速度
- ⑤ After turning on the main box, the back light of display will be gone off by the pushing of this switch. Then the program can be changeover by this switch.
开启主箱后,按一下此按钮,显示灯会熄灭,然后改变程序。

2. CONTROL PANEL OPERATION NOTES

控制面版使用说明

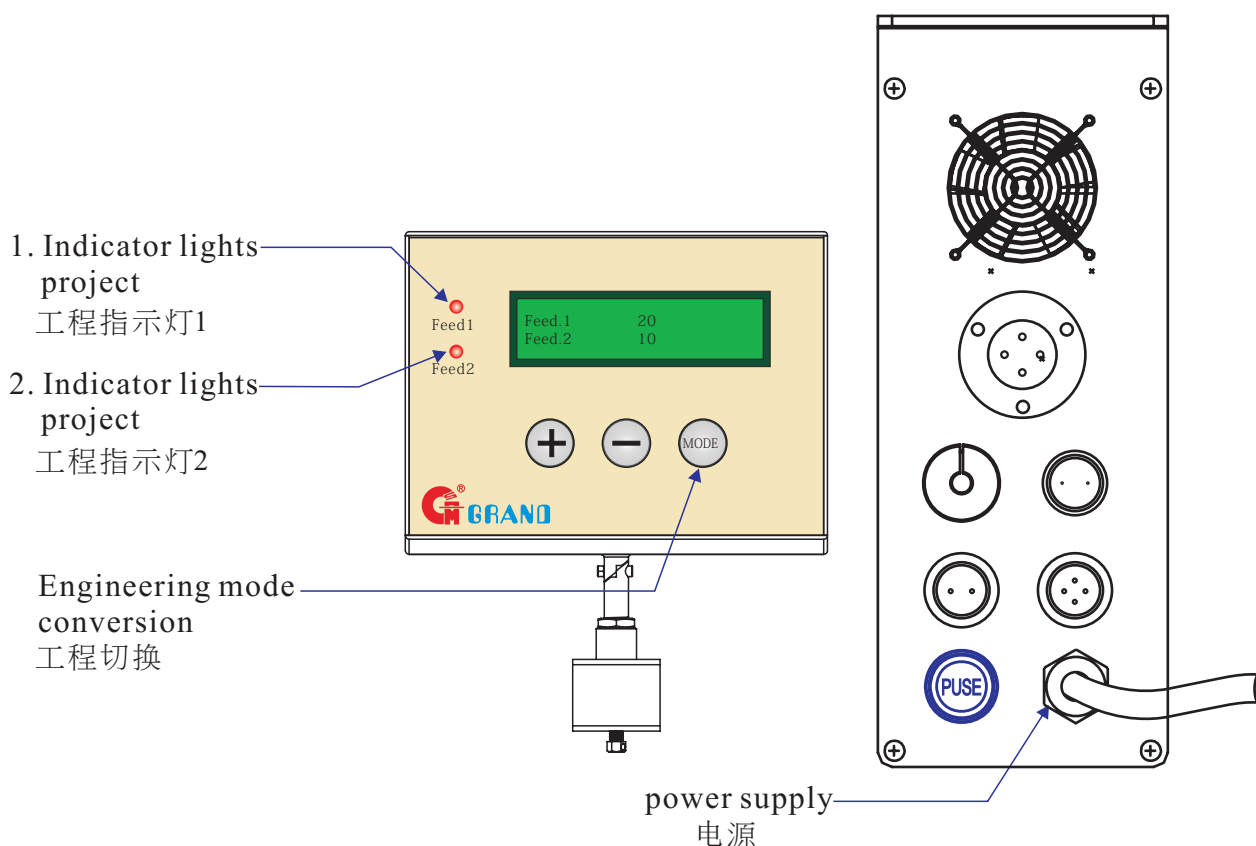

1) Adjusting the pressure of presser foot. Then turning on the IDF device

调节起压脚的压力■然后打开IDF装置。

2) Checking the illumination of detector light. Then pressing the reset switch.

检查指示灯■然后按下重启按键。

3) Checking the illumination of the red light of control panel.

检查控制面版指示灯。

4) Adjusting the feeding volume of both sewing machine and IDF device to almost same.

Trying to sew the sample fabric. Then adjusting the feeding volume by **+** and **-** button.

调整缝纫机和IDF的送带速度一致■尝试缝一块样品■然后通过“加”或“减”键调送带速度。

3) If the upper fabric was puchered, increasing the feeding volume of IDF device.

如果上面的布料要折成褶子■就增加IDF设备的上料量

If the lower fabric was puchered, reducing the feeding volume of IDF device.

如果下面的布料要折成褶子■就减少IDF设备的上料量

3. POWER SUPPLY BOX INSTRUCTION

电源控制盒说明

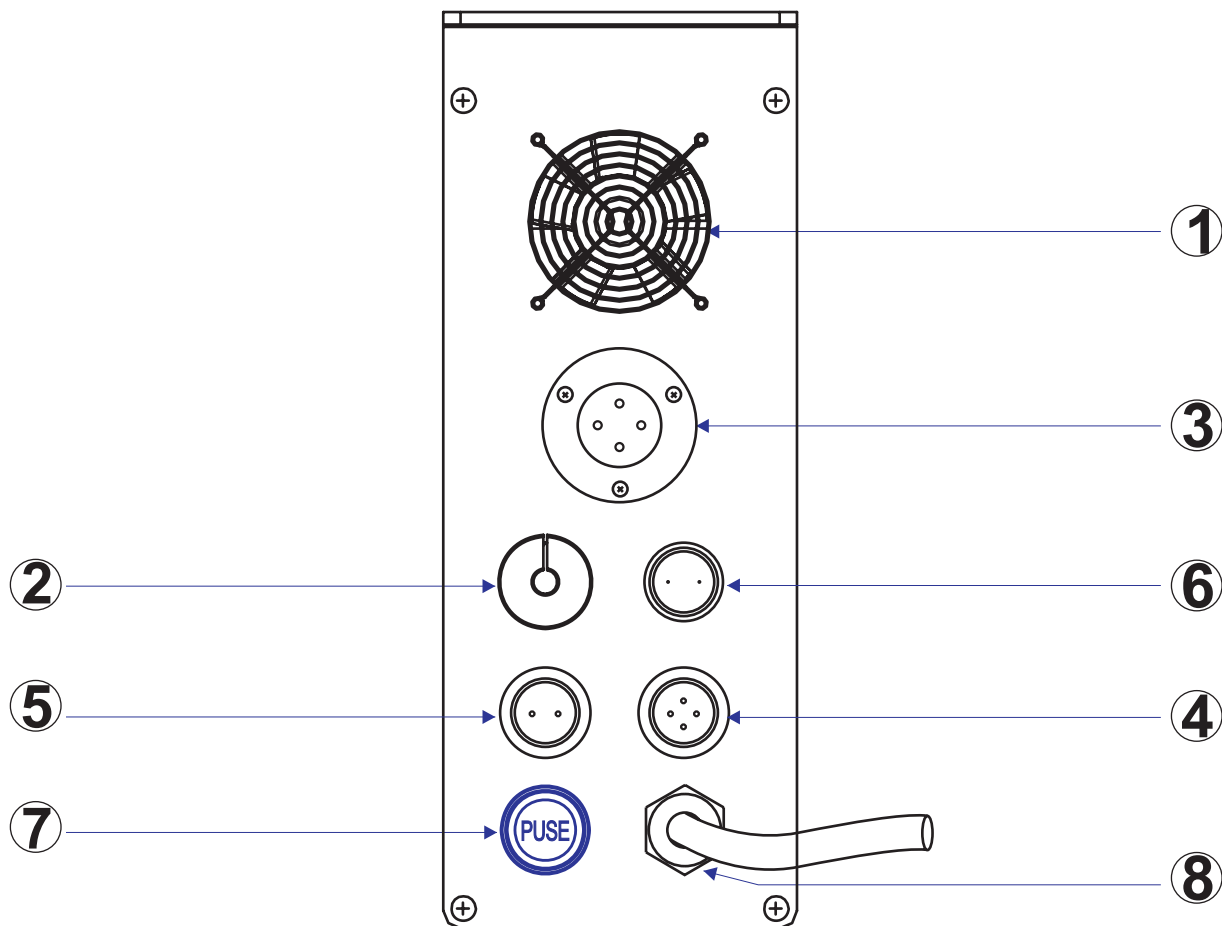

- ① Fan motor.
风扇电机
- ② Control panel.
控制面版
- ③ Motor connector (to connect the cord of IDF motor)
接马达插座
- ④ Connecting with the connector of pulse detector from sewing
连接缝纫机脉冲探测器
- ⑤ Connector of the switch (to connect the hand switch or foot switch).
开关插座 ■ 接手按钮或脚按钮 ■
Or of the bartucking and lockstitch sewing.
- ⑥ Electronic valve
电子阀
- ⑦ Fuse base
保险管
- ⑧ Power supply cord (must be used under 90-240V and connected
电源插头 (90-24以下接圆电线)
with ground wire)

4. ASSEMBLE METHOD

安装示意图

GBP-1

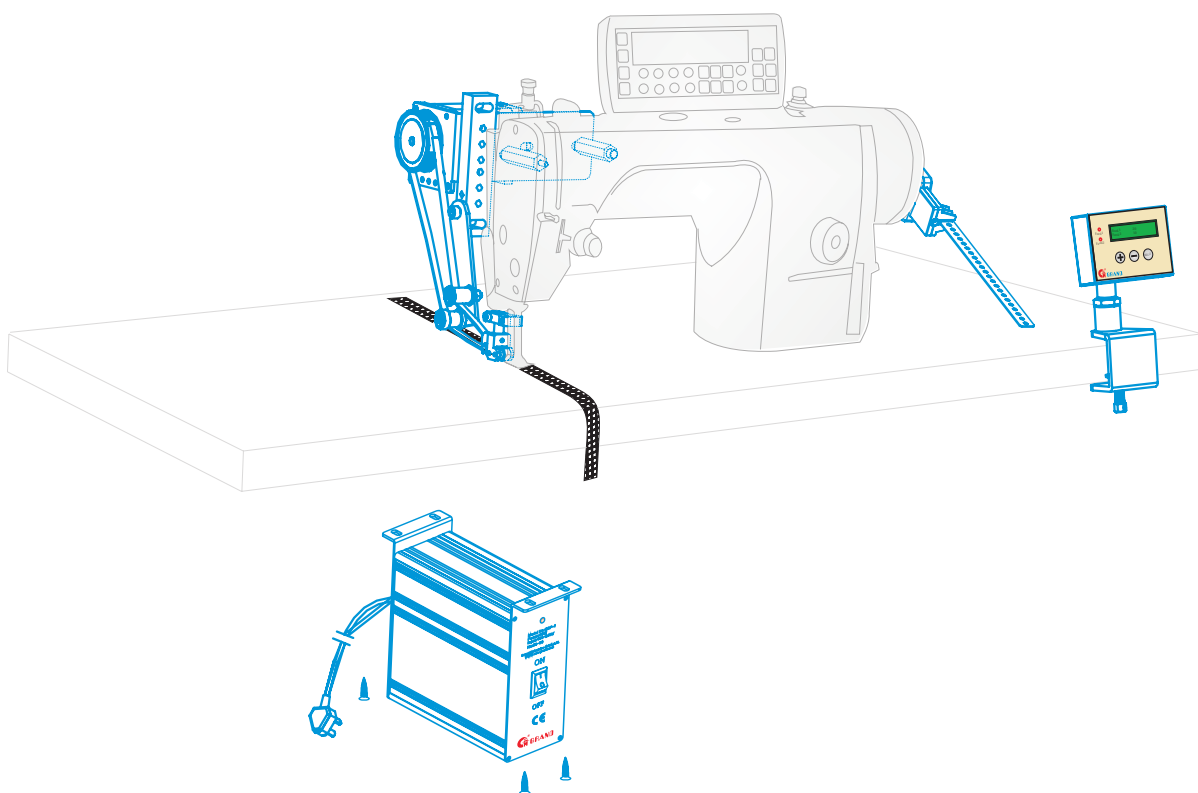

GBP-3

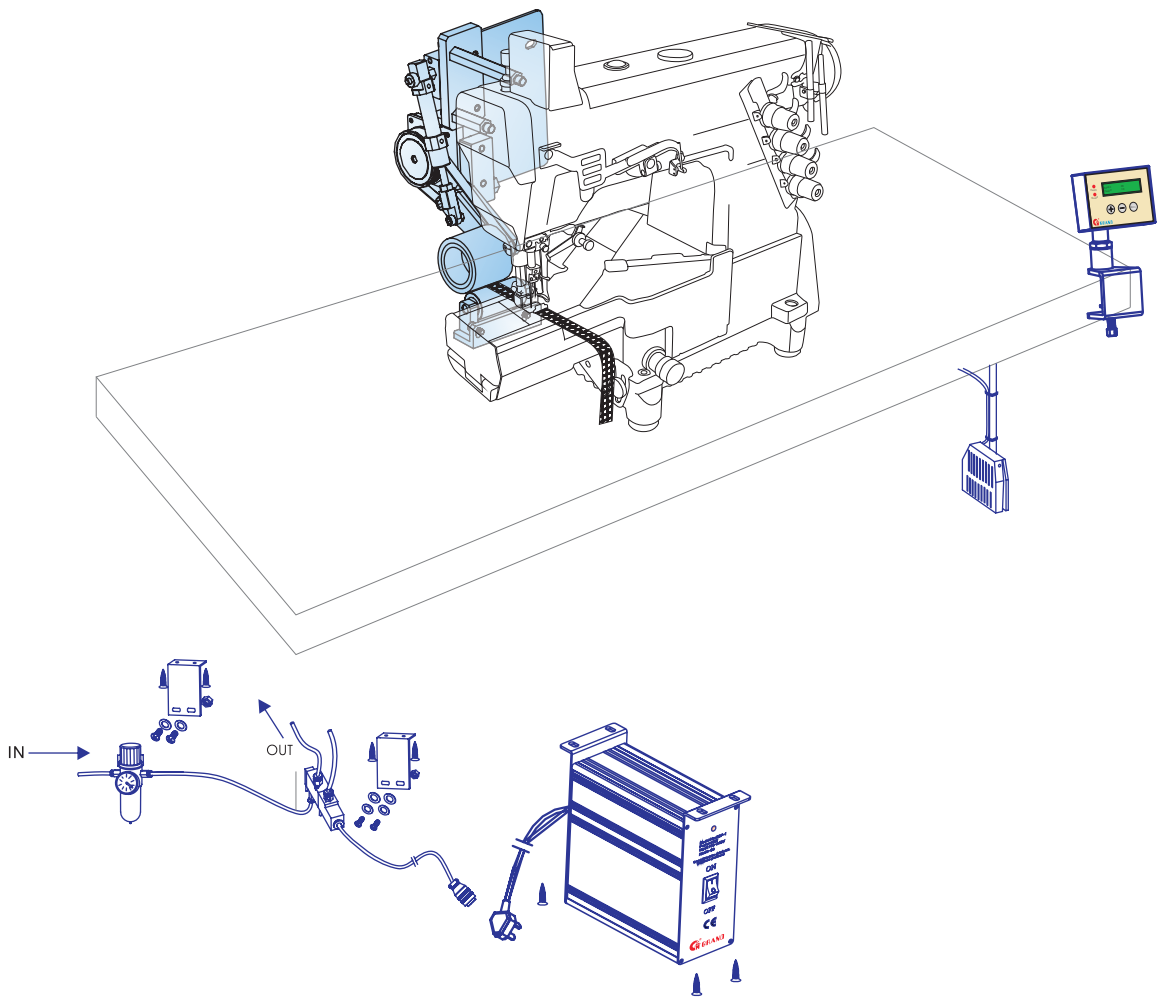

5. CONTROL BOX ASSEMBLY DRAWING AND LIST

控制盒装配图及清单

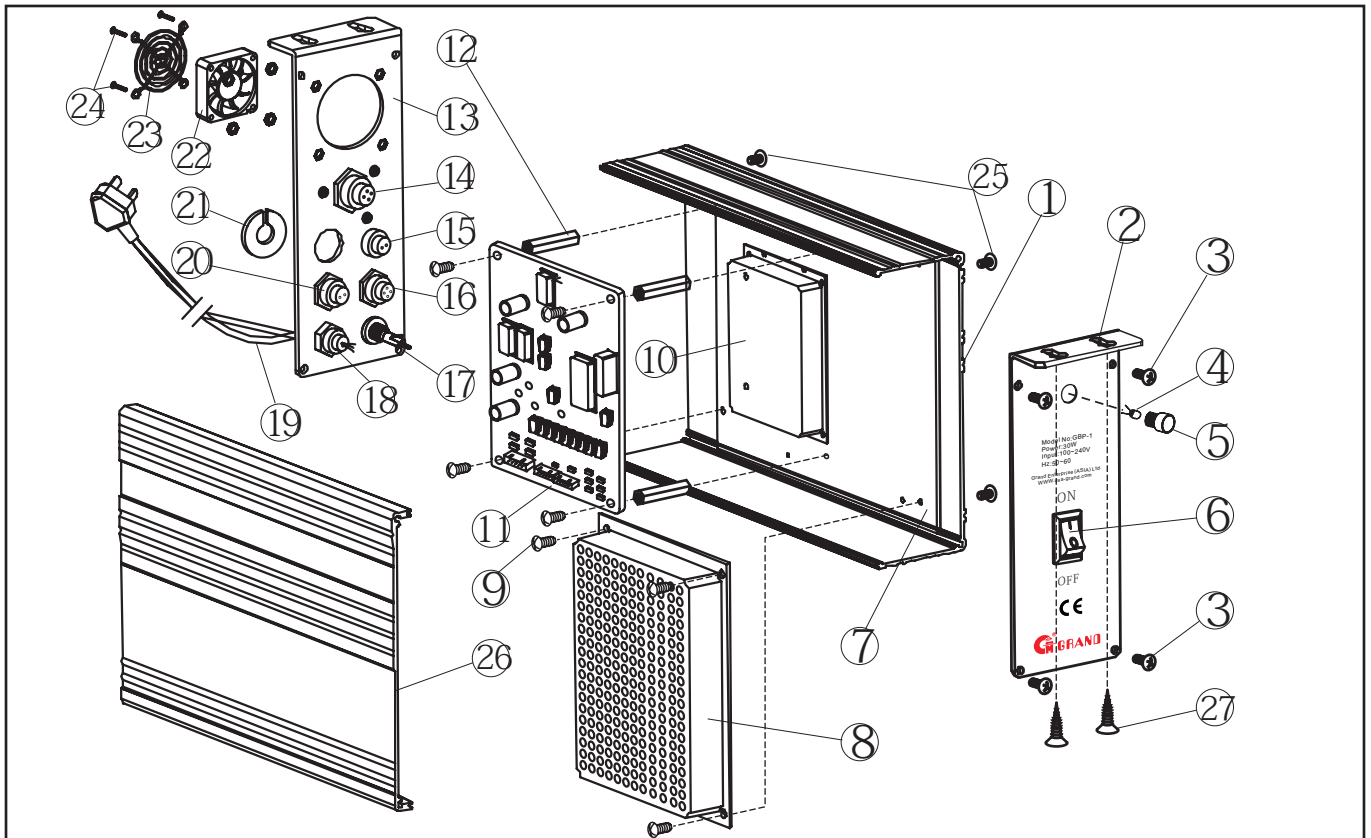

序号	型号	名称	数量	备注
Ref.No	Part No	Description	Qty	Remarks
1	WK-02	下盖	1	
2	GPB-2-19	前面板	1	
3	M4X10	十字圆头螺丝	8	
4	184-01	红灯	1	φ5
5	184-02	二极管专用灯座	1	φ5
6	250V/5A	二档位船型开关	1	
7	GPB-2-18A	PCB板安装架	1	
8	GC58-3PDB	开关电源	1	
9	M3X8	十字圆头螺丝	14	
10	DM432C	步进电机驱动器	1	
11	C	控制器线路板	1	
12	GPB-2-18B	铜柱	1	
13	GPB-2-20	后面板	1	
14	GX-19-4P	航空插座■大4芯■	1	
15	XS-12-2P	航空插座■2芯■	1	
16	GX-16-4P	航空插座■4芯■	1	
17	GAT36-012	保险座	1	
18	TJK2-026-6	电源线卡	1	
19	250V/10A	美式三扁插头电源线	1	
20	GX-16-2P	航空插座■2芯■	1	
21	GPB-2-21	防护圈	1	
22	DC12V/0.13A	风扇	1	40X40MM
23	40X40MM	风扇罩	1	
24	M3X15	十字圆头螺丝	4	
25	M4X8	十字圆头螺丝	4	
26	WK-01	上盖	1	
27	M4X16	十字沉头自功螺丝	4	

6. GBP-1 STEPPER MOTOR DRIVE ASSEMBLY DRAWING

GBP-1步进电机传动装配图

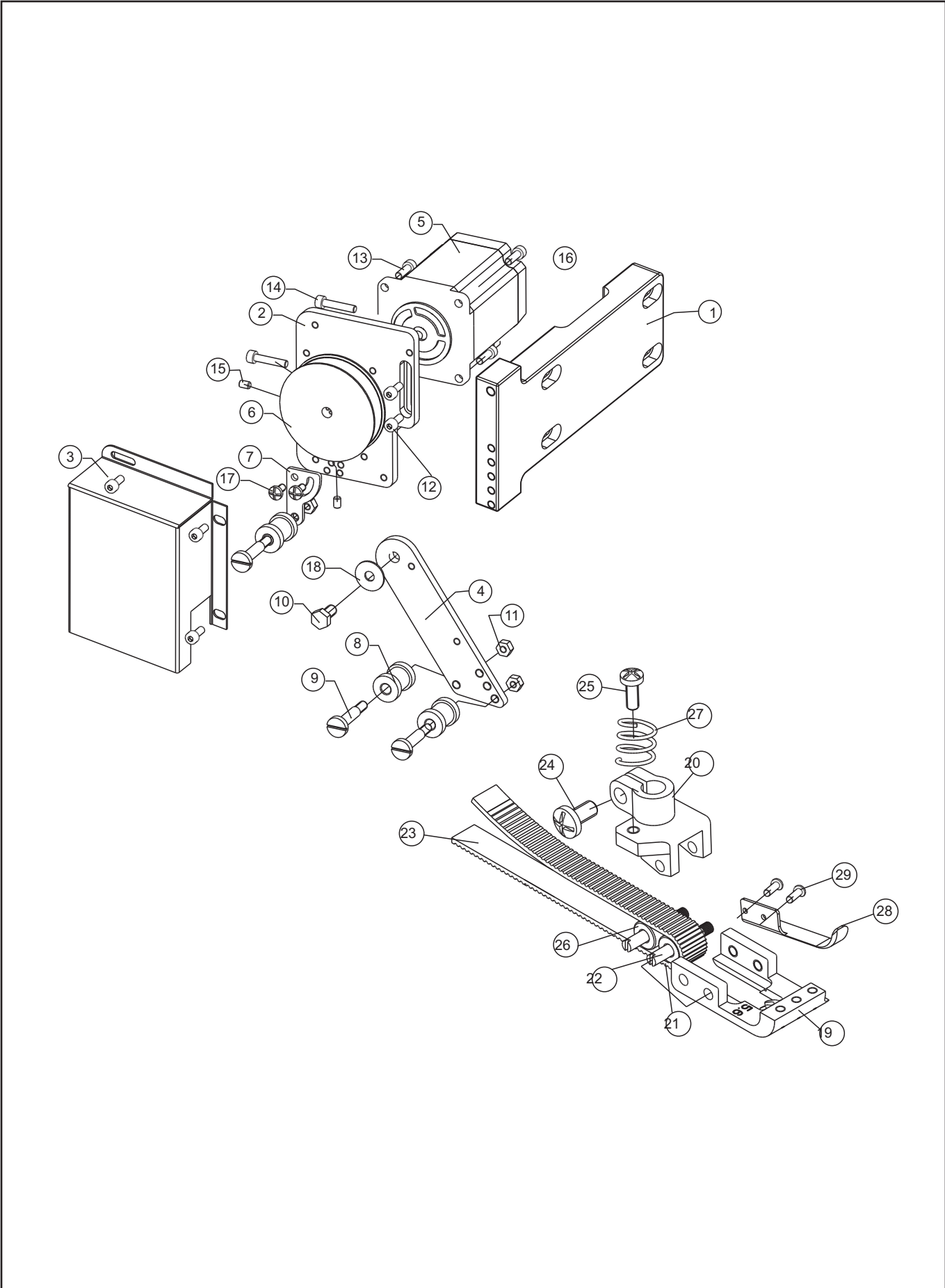

7. GBP-1 PARTS LIST FOR STEPPER MOTOR DRIVE SYSTEM

GBP-1步进电机传动清单

序号	型号	名称		数量	备注
Ref.No	Part No	Description		Qty	Remarks
1	GPB-1-01-JUKI7813	安装座	GPB-Installation bracket	1	
2	GPB-1-67-VF2500-v2	电机安装板	Motor bracket	1	
3		护罩	Bracket Cover	1	
4	GPB-1-50-B-V1	调节板	Adjustment bracket	1	
5	60HS30A 60	步进电机	60 Stepping motor	1	
6	GPB-1-19(72)	72齿T2.5同步轮	Synchronous wheel	1	
7	GPB-1-18	调节片	Adjustment plate	1	
8	GPB-1-14A-V1	定位轮	Locating wheel	3	
9	GPB-1-15-V1	定位轮轴	locating wheel axis	3	
10	M6X12	外六角头螺栓	Outer hex head bolt	1	
11	M4	六角螺母	Nut	3	
12	M4X10	内六角圆柱头螺钉	Inner hex head screw	2	
13	M4X12	内六角圆柱头螺钉	Inner hex head screw	4	
14	M4X20	内六角圆柱头螺钉	Inner hex head screw	3	
15	M4X6	内六角平端紧定螺钉	Inner hex headless screw	2	
16	M6X30	内六角圆柱头螺钉	Inner hex headless screw	2	
17	M4X8	十字槽盘头螺钉	Cross recess head screw	5	
18	φ 6Xφ18	平垫圈	φ 6Xφ18Washer	1	
19	Y-01-V2	缝纫机5.6针位压脚	5.6 Press foot	1	
20	Y-03	绷缝机压脚固定件	Press foot fixed part	1	
21	GPB-1-07A-V1	绷缝机铜套	Copper sleeve	1	
22	GPB-1-08A	绷缝机铜套轴	Copper sleeve	2	
23	Y-05	T2.5X500X8皮带	T2.5X500X8 Belt	1	
24	M4X8	内六角圆柱头螺钉	Inner hex head screw	1	
25	M3X12	内六角圆柱头螺钉	Inner hex head screw	1	
26	GPB-1-07B	绷缝机铜套-B	Copper sleeve-B	1	
27	S24273-08	弹簧B	Spring B	1	
28	GPB-1-12A	延伸压脚片	Extended sheet	1	
29	M2X3	十字沉头	Cross recess head screw	2	

8. GBP-3 STEPPER MOTOR DRIVE ASSEMBLY DRAWING

GBP-3步进电机传动装配图

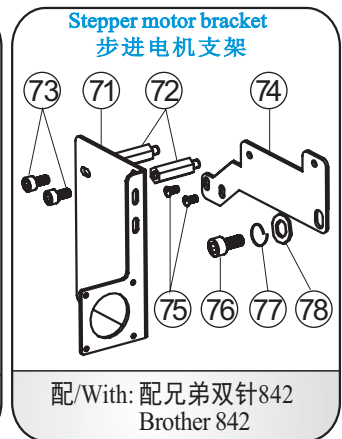
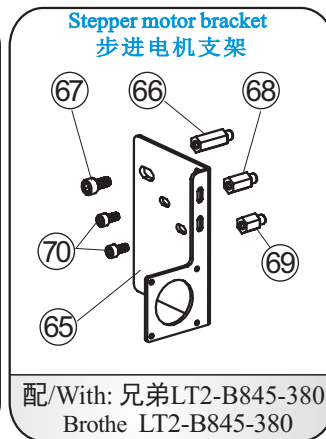
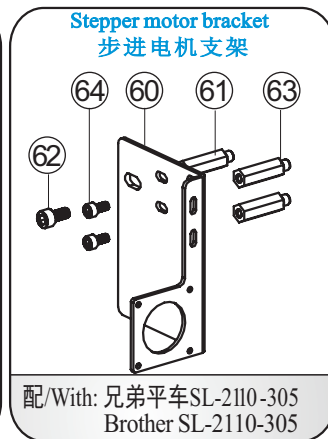
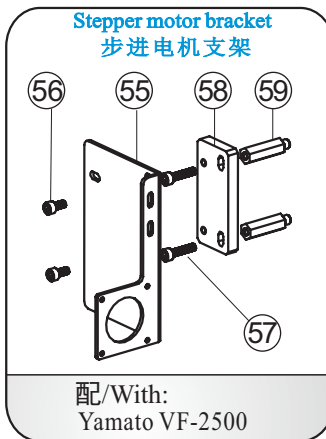
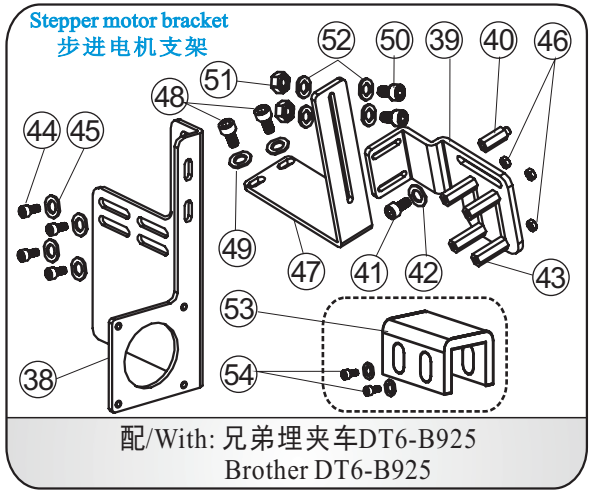
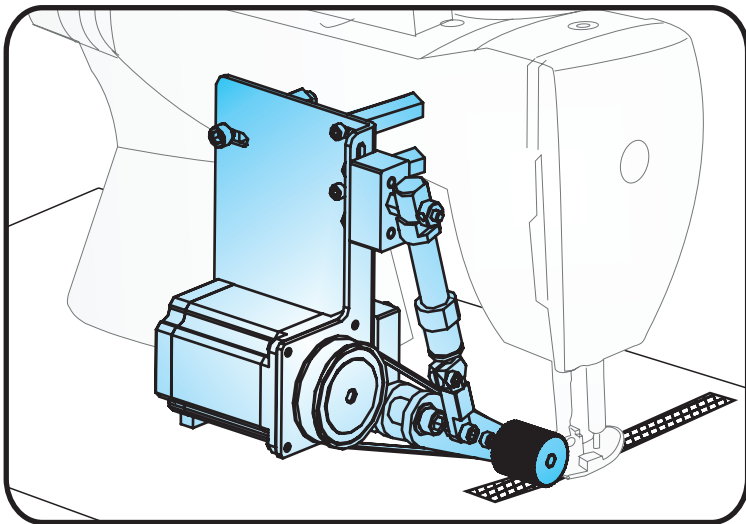
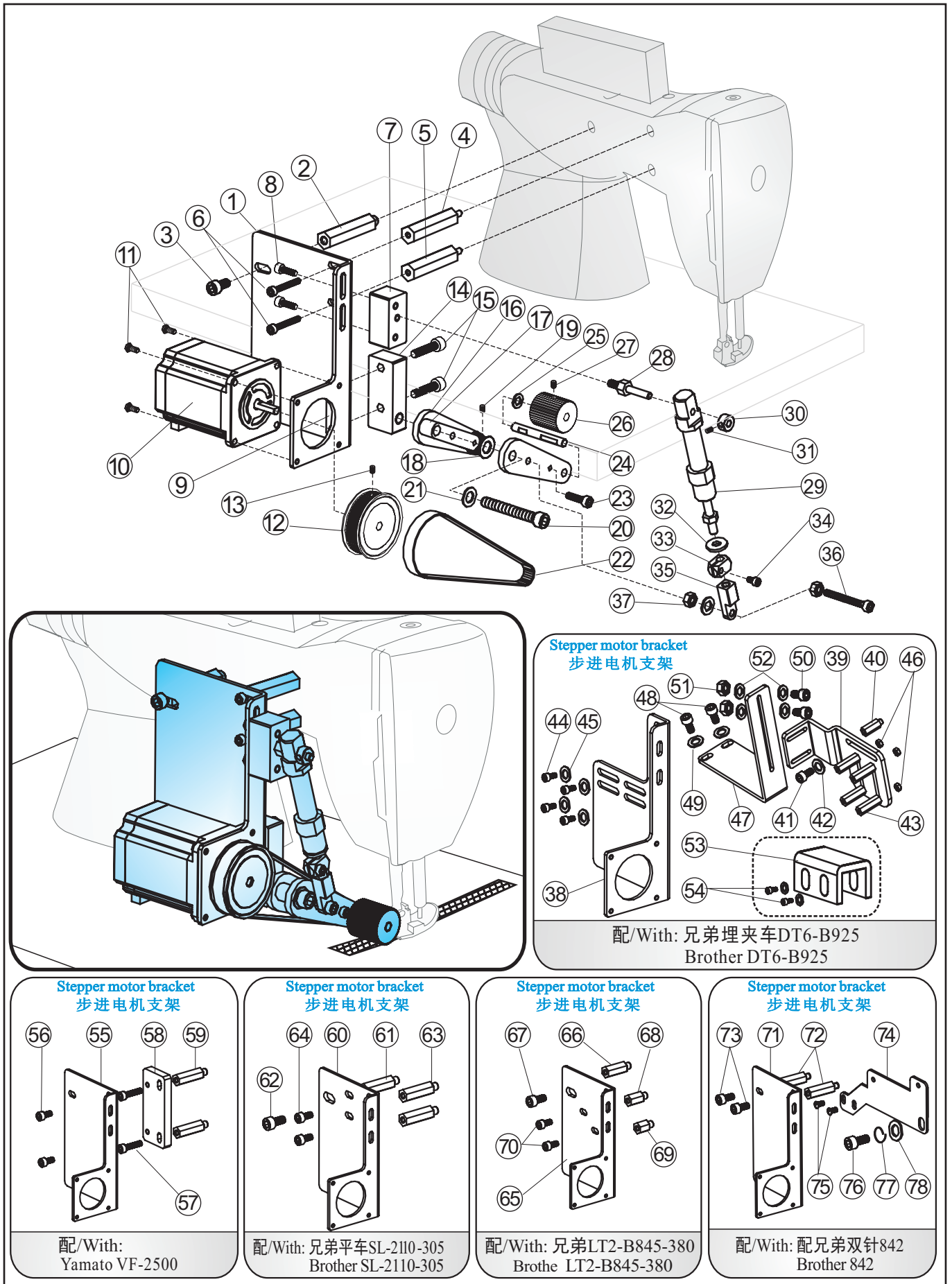

9. GBP-3 PARTS LIST FOR STEPPER MOTOR DRIVE SYSTEM

GBP-3步进电机传动清单

序号	型号	名称		数量	备注
Ref.No	Part No	Description		Qty	Remarks
1	GPB-2-09	步进电机支架	Stepper motor bracket	1	配/with:JUKI-DDL-8700-7
2	GPB-2-11	顶高柱A	Column A	1	配/with:JUKI-DDL-8700-7
3	M6X12	内六角圆柱头螺丝	Screw	1	With 1 flat washersa
4	GPB-2-10	顶高柱B	Column B	1	配/with:JUKI-DDL-8700-7
5	GPB-2-12	顶高柱C	Column C	1	配/with:JUKI-DDL-8700-7
6	M4X12	内六角圆柱头螺丝	Screw	2	With 2 flat washersa
7	GPB-2-08	气缸固定件	Cylinder fittingsc	1	
8	M5X14	内六角圆柱头螺丝	Screw	2	With 2 flat washersa
9	GPB-2-12	固定块	Fixed block	1	
10	BS57HB51	步进电机	Stepping Motor	1	
11	M4X8	十字圆头螺丝	Screw	4	
12	GPB-1-19	同步带轮(60-T2.5)	Timing belt pulley	1	
13	M4X6	内六角紧定螺丝	Screw	1	
14	GPB-2-07	活动轮固定件	Activity wheel mountings	1	
15	M6X25	内六角圆柱头螺丝	Screw	2	
16	GPB-2-04	压轮安装板	Roller mounting plate	2	
17	GPB-2-05	垫高块	Booster block	1	
18	GPB-2-01	同步带轮(18-T2.5)	Timing belt pulley	1	
19	M4X2.5	内六角紧定螺丝	Screw	1	
20	M8X55	内六角圆柱头螺丝	Screw	1	With 1 nuts
21	φ8	平垫	Washer	1	
22	M4X12	内六角圆柱头螺丝	Screw	1	With flat washers, nuts each 1
23	T2.5X335	同步带	Synchronous belt drive	1	
24	GPB-2-03	压轮轴	Press wheel	1	
25	φ6	平垫	Washer	1	
26	GPB-2-02	压布轮	Feed wheel	1	
27	M4X6	内六角紧定螺丝	Screw	2	
28	QD-13	螺杆	Screw	1	
29	12X10	气缸	Cylinder	1	
30	QD-10	紧定套A	Adapter sleeve A	1	
31	M4X4	内六角紧定螺丝	Screw	1	
32	φ6.5Xφ16X2	平胶垫	Flat pad	1	
33	CTP-2-02	锁紧块	Latch segment	1	
34	M4X10	内六角圆柱头螺丝	Screw	1	
35	GPB-2-13	气缸顶头	Cylinder head	1	
36	M4X35	内六角圆柱头螺丝	Screw	1	With 2 flat washers
37	M4	六角螺母	Nuts	2	
配不同的机型用不同的安装架/Different models with different mounting brackets					
38	GPB-2-33	步进电机支架	Stepper motor bracket	1	配/with:Brother DT6-B925
39	GPB-2-38	机头安装板	Head mounting plate	1	配/with:Brother DT6-B925
40	GPB-2-36	顶高柱B	Column B	1	配/with:Brother DT6-B925
41	M8X12	内六角圆柱头螺丝	Screw	1	配/with:Brother DT6-B925
42	φ8	平垫	Washer	1	配/with:Brother DT6-B925
43	GPB-2-35	顶高柱A	Column A	4	配/with:Brother DT6-B925

序号	型号	名称		数量	备注
Ref.No	Part No	Description		Qty	Remarks
44	M6X14	内六角圆柱头螺丝	Screw	4	配/with:Brother DT6-B925
45	φ6	平垫	Washer	4	配/with:Brother DT6-B925
46	M6	六角螺母	Nuts	4	配/with:Brother DT6-B925
47	GPB-2-34	底座固定板	Fixed base plate	1	配/with:Brother DT6-B925
48	SM5/16-28	内六角圆柱头螺丝	Screw	3	配/with:Brother DT6-B925
49	φ8	平垫	Washer	1	配/with:Brother DT6-B925
50	M6X20	内六角圆柱头螺丝	Screw	2	配/with:Brother DT6-B925
51	M6	六角螺母	Nuts	2	配/with:Brother DT6-B925
52	φ8	平垫	Washer	4	配/with:Brother DT6-B925
53	GPB-2-40A	轮子底板	Bottom wheel	1	配/with:Brother DT6-B925
54	M3X8	内六角螺丝(配平垫圈)	Screw	2	配/with:Brother DT6-B925
55	GPB-2-09A	步进电机支架	Stepper motor bracket	1	配/with:yamato VF-2500
56	M6X12	内六角圆柱头螺丝	Screw	2	配/with:yamato VF-2500
57	M6X25	内六角圆柱头螺丝	Screw	2	配/with:yamato VF-2500
58	GPB-2-14	机头固定件	Head fittings	1	配/with:yamato VF-2500
59	GPB-2-15	顶高柱	Column	2	配/with:yamato VF-2500
60	GPB-2-27	步进电机支架	Stepper motor bracket	1	配/with:Brother SL-2110-305
61	GPB-2-25	顶高柱1	Column	1	配/with:Brother SL-2110-305
62	M6X12	内六角圆柱头螺丝	Screw	1	配/with:Brother SL-2110-305
63	GPB-2-26	顶高柱2	Column	2	配/with:Brother SL-2110-305
64	M4X12	内六角圆柱头螺丝	Screw	2	配/with:Brother SL-2110-305
65	GPB-2-28	步进电机支架	Stepper motor bracket	1	配/with:Kingtex LT2-B845-380
66	GPB-2-31	顶高柱C	Column C	1	配/with:Kingtex LT2-B845-380
67	M6X12	内六角圆柱头螺丝	Screw	1	配/with:Kingtex LT2-B845-380
68	GPB-2-30	顶高柱D	Column D	1	配/with:Kingtex LT2-B845-380
69	GPB-2-29	顶高柱E	Column E	1	配/with:Kingtex LT2-B845-380
70	M4X12	内六角圆柱头螺丝	Screw	2	配/with:Kingtex LT2-B845-380
71	GPB-2-09A	步进电机支架	Stepper motor bracket	1	配/with:Brother 842
72	GPB-2-21	顶高柱	Column	2	配/with:Brother 842
73	M6X12	内六角圆柱头螺丝	Screw	2	配/with:Brother 842
74	GPB-2-20	机头安装板	Head mounting plate	1	配/with:Brother 842
75	SM11/64-40X12.5	一字圆头螺丝	Screw	2	配/with:Brother 842
76	M8X16	内六角圆柱头螺丝	Screw	1	配/with:Brother 842
77	φ8	平垫圈	Washer	1	配/with:Brother 842
78	φ8	弹垫圈	Spring washer	1	配/with:Brother 842

10. PHOTOELECTRIC SENSOR ASSEMBLY DRAWING AND LIST

光电传感器装配图及清单

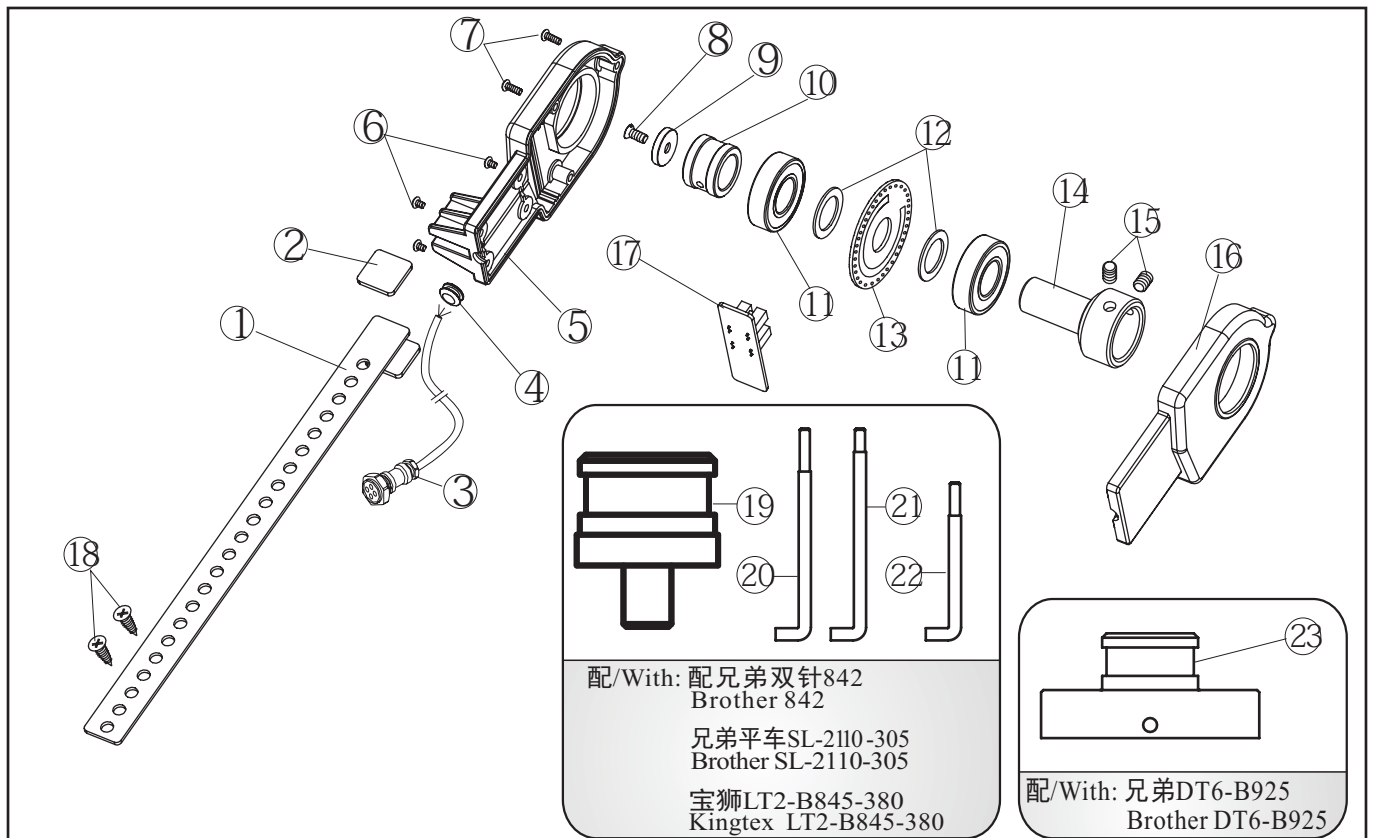

序号 Ref.No	型号 Part No	名称 Description	数量 Qty	备注 Remarks
1	GPB-1-26	定位片 Orientation piece	1	
2	GPB-1-27	防滑片 Anti-skid film	2	
3	GX-16-4P	航空插头4芯 Aeronautic plugs (4 cores)	1	
4	φ6	护线圈 Retaining coil	1	
5	GPB-1-28	后盖 Back cover	1	
6	M3X8	十字圆头螺丝 Screw	4	
7	M3X15	十字圆头螺丝 Screw	3	
8	M3X12	十字沉头螺丝 Screw	1	
9	GPB-1-23	锁紧片 Tightening cover	1	
10	GPB-1-22	轴承定位圈 Bush for pressing bearing	1	
11	6002	轴承 Bearing	2	
12	GPB-1-21	平垫圈 Flat washer	2	
13	GPB-1-20	光电开关片 Photoelectric switch chip	1	
14	GPB-1-25	传动轴 Counter shaft	1	
15	M6X5	内六角紧定螺丝 Screw	2	
16	GPB-1-29	前盖 Front cover	1	
17	GPB-1-24	光电开关PCB Photoelectric switch PCB	1	
18	M5X22	十字沉头自功螺丝 Screw	2	
19	GPB-2-22	光电计数器固定件 Photoelectric counter mountings	1	
20	GPB-2-32	计数器固定柱 Counter fixed column	1	配/with:Kingtex LT2-B845-380
21	GPB-2-23	计数器固定柱 Counter fixed column	1	配:Brother SL-2110-305/842
22	GPB-2-16	计数器固定柱 Counter fixed column	1	配/with:yamato VF-2500
23	GPB-2-37	光电计数器固定件 Photoelectric counter mountings	1	配/with:Brother DT6-B925

11. CONTROLLER ASSEMBLY DRAWING AND LIST

控制器装配图及清单

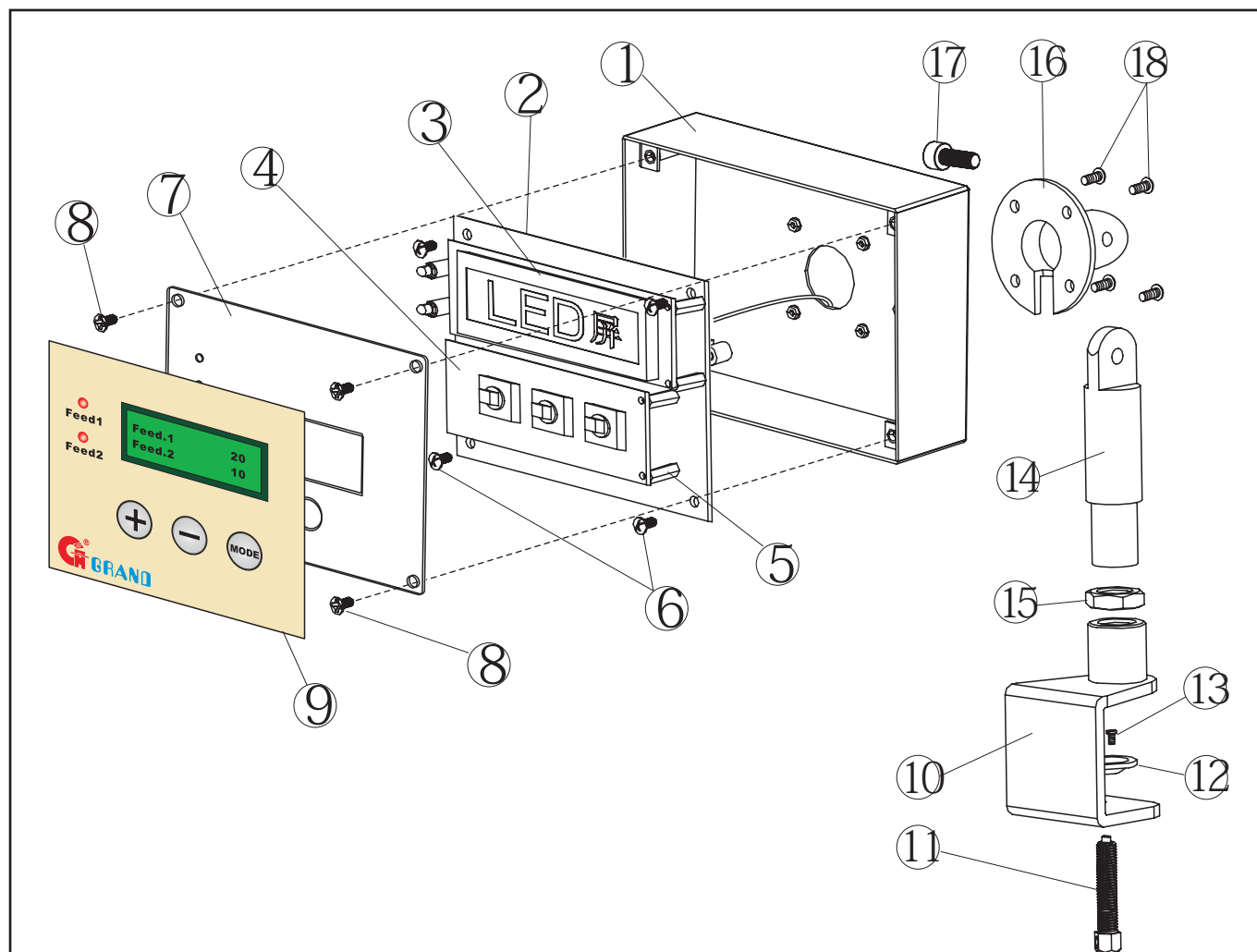

序号	型号	名称		数量	备注
Ref.No	Part No	Description		Qty	RemarkS
1	GPB-1-32	控制器外壳焊接件	Controller shell weldment	1	
2	A	显示控制PCB组件板	Display panels	1	
3	LMB162NBA	LCD显示器	LCD Monitor	1	
4	B	按键线路PCB组件板	Button circuit board	1	
5	GPB-1-33	铜柱	Copper cylinder	1	
6	M3X6	十字圆头螺丝	Screw	4	
7	GPB-1-31	控制器面板	Control panel	1	
8	M3X6	十字沉头螺丝	Screw	4	
9	GPB-1-30	面板贴纸	Panel sticker	1	
10	MDF8-2-08	卡钳座	Base parts	1	
11	GM-8-41	螺杆	Threaded rod	1	
12	GM-8-40	压盖	Clip washer	1	
13	M3X6	十字圆头带垫片螺丝	Screw	1	
14	CTP-2B-36	控制器支撑杆	Strut bar	1	
15	M18X1.5	薄螺母	Screw	1	
16	GPB-1-35	支撑件	Front cover	1	
17	M6X16	内六角圆柱头螺丝	Screw	1	
18	M4X7	十字圆头螺丝	Screw	4	

12. GBP-3 FOOT SWITCH AND PRESSURE COMPONENTS

GBP-3脚踏开关与气压部件

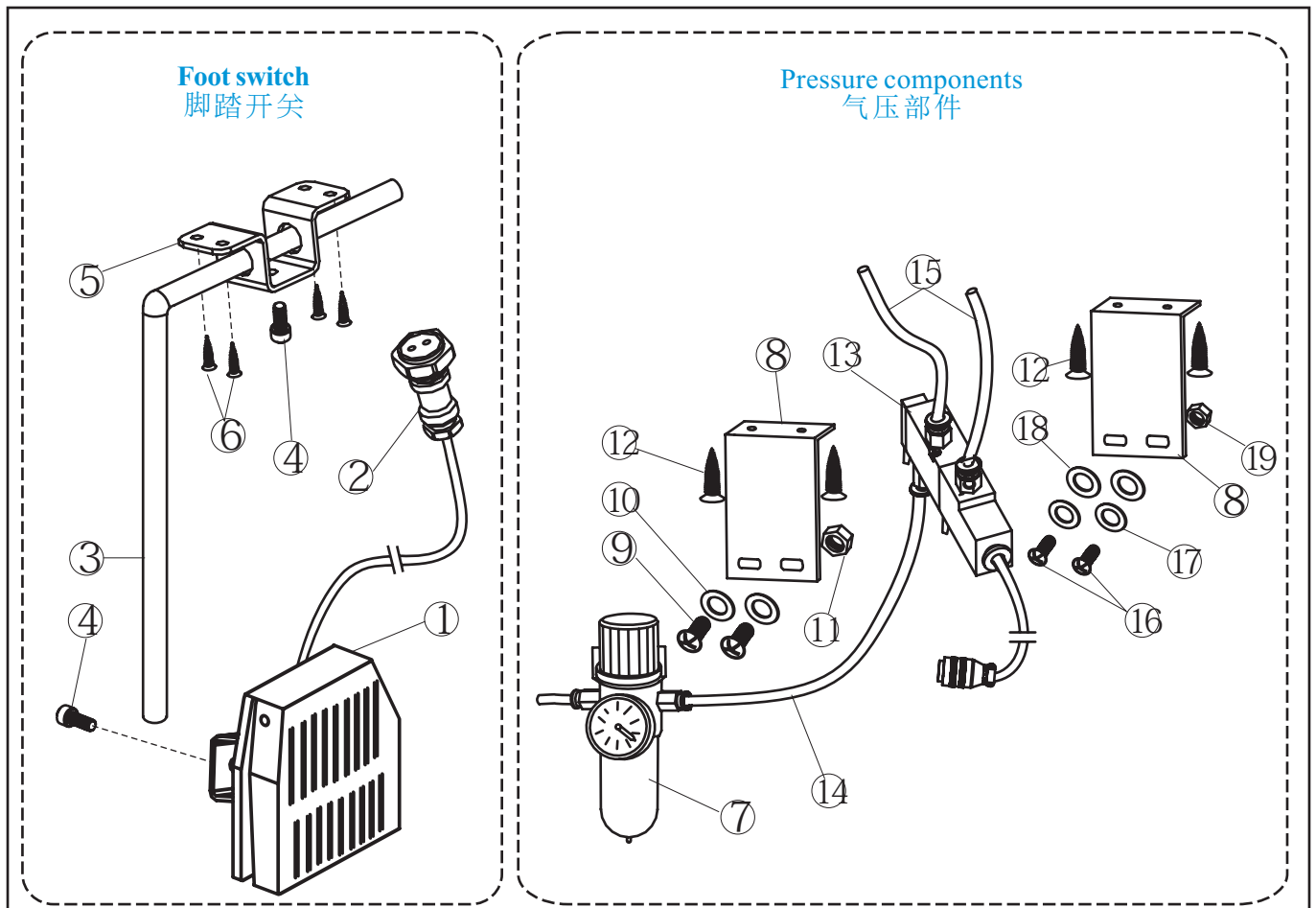

序号 Ref.No	型号 Part No	名称 Description		数量 Qty	备注 Remarks
1	250V 10A	脚踏开关	Footswitch	1	
2	GX-16-2P	航空插头2芯	Aeronautic plugs (2 cores)	1	
3	KS-3	L型支杆	Strut	1	
4	M6X10	内六角螺丝	Screw	2	
5	KS-2	弓型件	Arch-type fittings	1	
6	ST4X16	十字沉头自功螺丝	Screw	4	
7	A-1220	调压过滤阀	Marsh bellofram	1	
8	GA101-27	L型片	L-type films	2	
9	M5X10	十字圆头螺丝	Screw	2	
10	φ5	平垫圈	Washer	2	
11	M5	六角螺母	Nuts	2	
12	ST5X25	十字沉头自功螺丝	Screw	4	
13	E202-1	电磁阀	Solenoid valve	1	
14	A-125Xφ6	气管	Trachea	1	
15	A-125Xφ4	气管	Trachea	2	
16	M3X25	十字圆头螺丝	Screw	2	
17	φ3	平垫圈	Washer	2	
18	φ4	平垫圈	Washer	2	
19	M3	六角螺母	Nuts	2	



中國裝配&銷售中心

中山百川匯盈精密實業有限公司

Zhongshan Grand Precision Industrial Ltd.

地址: 广东省中山市东区起湾道北136号

NO. 136, Qiwan Road North, East District,

Zhongshan City, Guangdong Province, China

TEL: (86) 760-88414888

FAX: (86) 760-88414668

<http://www.usa-grand.com>

Email:sales@usa-grand.com

sale@usa-grand.com