

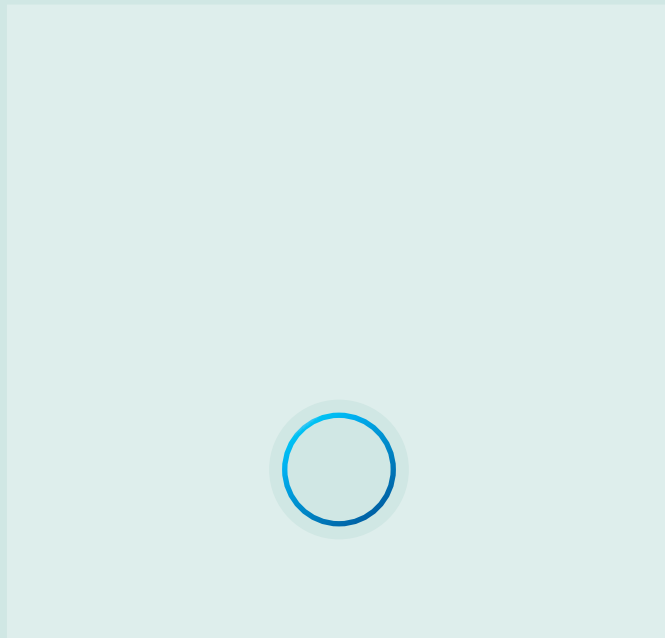

The Ultimate Switch





CREATING SPLENDOUR...



AWARD-WINNING AESTHETICS AND INNOVATION

ULTI is for discerning consumers who seek haute couture in interior design. The premium ULTI range marries the highest aesthetics in contemporary décor with superb functionality and pioneering technology. It delights the senses and brings you to another level of inspired green comfort living.

With its ultra-clean lines, sleek square profile and instantly identifiable round dolly, the ULTI collection is the measure of beauty and ingenuity, creating unprecedented modern simplicity.

ULTI's inventive excellence has also been recognized by prestigious industry bodies worldwide.



SMOOTH OPERATOR

Whereas traditional switches use rocker mechanisms with angled dollies, ULTI mechanical switches are empowered by the patented i.m.press mechanism. This sets free the design paradigm and enables the switches to look and perform every bit as stylishly as their electronic counterparts.



THE SECRET WITHIN

ULTI's unique iso-motion-press (i.m.press) mechanism ensures switches stay in a uniform position and can be swiftly and surely operated with a simple motion. With dollies maintaining the same position, whether on or off, i.m.press empowers the world's first ever fully flush-faced 250V-rated mechanical switch.

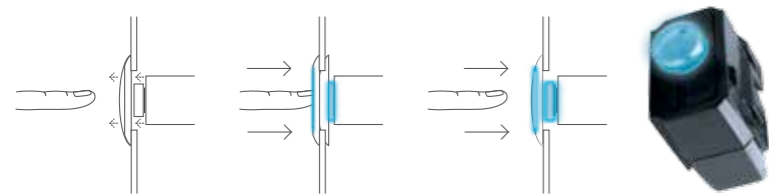



GROUNDBREAKING HOME CONTROL

If you think that home automation is expensive, complex to install and difficult to use, think again.

While most home control systems require extensive rewiring and troublesome home renovations in order to connect all the components, ULTI's EZinstall3 mini home control system uses an innovative wireless network. This eliminates the need for costly and complicated rewiring but gives you all the benefits of a state-of-the-art smart home.

INSTALL A POWERFUL
HOME CONTROL SYSTEM
IN MINUTES



ULTI EZinstall3 TruRetrofit wireless technology can be installed in around five minutes. Simply remove your original switches and replace them with the ULTI design of your choice.

With ZigBee peer-to-peer standard wireless, each ULTI EZinstall3 switch becomes a node in your very own home control network.

Virtually unlimited in range and scalability, your ULTI EZinstall3 network can be accessed wirelessly regardless of your decorating materials. There's no better and faster way to upgrade an older building with home control.

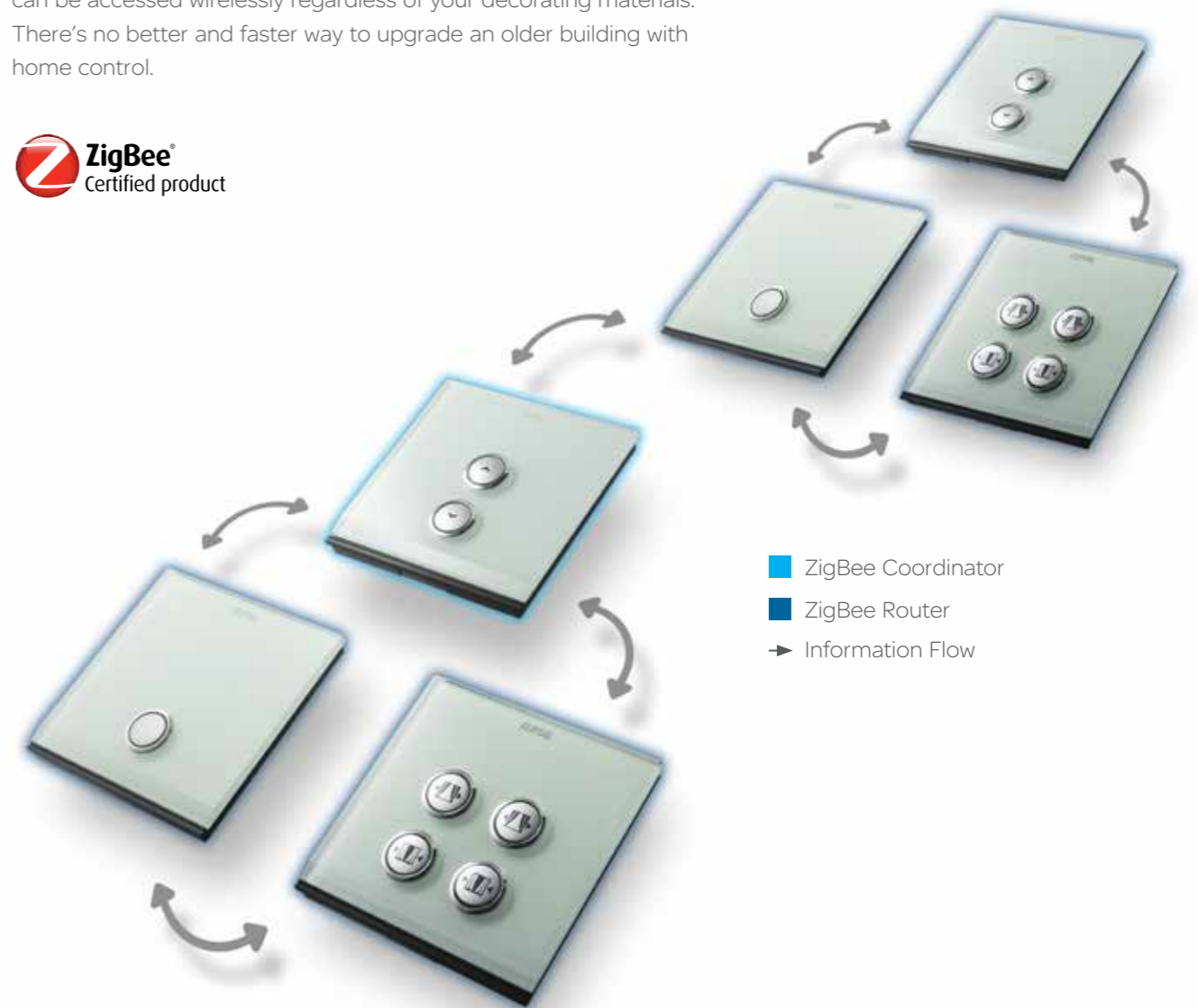



INTEGRATED SOLUTION CONTROLS

The new generation ULTI EZinstall3 is much more than a wireless, lighting control system. Advanced technology has transformed it into a mini home control system when combined with the revolutionary ULTI IP gateway and IR converter.

ULTI IP gateway – your home's nerve centre

The ULTI IP gateway adds a whole new level of functionality and connectivity to ULTI EZinstall3.

Just connect your ULTI IP gateway with ULTI EZinstall3 devices to be able to run your home the smart way. The user interface is easy to understand and ensures effortless home control on a daily basis.



Remote TV and air-conditioning control

By adding a compact and inconspicuous IR converter, the ULTI EZinstall3 controls your TV. Use your mobile device to select your favorite channel, and access the volume and on/off controls.

ULTI EZinstall3 can also control your air-conditioning to keep you in your comfort zone and save energy when you're not at home.

Automatic dimmable light detection

With a single touch, ULTI can recall pre-programmed light combinations. Choose the perfect ambience for an evening of family fun, elegant entertainment or a romantic dinner.

However, the light bulb industry is fast evolving. Although LED and CFL lamps are currently at the forefront of lighting trends, these lights create problems with traditional dimming devices.

ULTI's EZinstall3 dimtect technology automatically detects the type of bulb used and provides dimming when possible. Dimtect also provides on/off functionality for non-dimmable lamps.

A fully integrated home control system.





User-friendly interface

The ULTI EZinstall3 mini home control system GUI design is perfectly straightforward. Easy-to-understand icons represent your various devices or you can use your favorite images to symbolize scenes and scheduling. Keep your most frequently used functions on your home page. Resize the icons and personalize your interface.

Multi-mobile compatible

The ULTI GUI is simultaneously compatible with both IOS and Android platforms.



Green comfort living

Lighting and air-conditioning are the biggest consumers of energy in the home. ULTI's EZinstall3 time scheduling helps you to achieve the optimal balance of comfort and energy conservation.

Precise control over the functioning of your home's lighting, air-conditioning, curtains and heating means a living environment tailored to your ideal comfort. Pre-set programs can run automatically, helping you to conserve energy, become more eco-friendly and save money.

Out of home control

Remotely control your home from anywhere in the world, whenever you require it, via your mobile device with ULTI EZinstall3.

Forget to turn off your lights or air-conditioner? You can access your home with ULTI on your mobile device. And if you're out and about, you can select your desired temperature and lighting to greet you when you arrive home.

Enhanced Dynamic Labelling Technology (eDLT) Input Unit

The ULTI C-Bus eDLT provides sophisticated and user-friendly control of C-Bus system with innovative features such as dual action buttons, high resolution color screen and status information like temperature and time. Put, simply, the ULTI C-Bus eDLT is the most advanced wall switch.



TOTAL CONTROL OVER YOUR HOME

Imagine how much simpler and more satisfying life would be if you could control all your security systems, AV equipment, household appliances, and energy monitoring via a single ultra-sleek controller.

Enjoying full control is only half the story. With ULTI, you can tailor-make home living any way your routine demands. Now, entertainment is no longer confined to your sitting or music room; sensors monitor and inform you instantly and automatically of potential mishaps around your home; household systems such as air conditioning and lighting “wake up” and work according to your precise wishes. Best of all, you’ll also enjoy the unique peace of mind of being able to remotely access, monitor and control your home from anywhere and at anytime.

Living stylishly, living well and being 100% eco-friendly – that’s the beauty of ULTI!

C-BUS™ CONVERGED INTELLIGENCE

C-Bus Technology™ is a futuristic alternative to conventional wiring that delivers extra functionality. This microprocessor-based system enables integrated control and management of virtually any type of electrical load, digital and analogue. You can set the operating variables and control relationships between C-Bus linked units. The system’s innovative modular design and distributed intelligence also enhances set-up, maintenance and scaling efficiency with a single connection controlling an unlimited number of devices. Open protocol architecture ensures unrivalled interoperability. With C-Bus, you’ll never have to worry about the control and integration of various devices being compromised by differences in origin, technology or brand.



THE TRAVELER'S STYLISH ANSWER TO POWER AND CONNECTIVITY

Modern guests rarely stay at a hotel without bringing their smart phone, laptop computer, digital camera, MP3 or even PMP. Ensure their every stay with you is complete by equipping your rooms and suites with an EPIC Organiser. Your guests will enjoy the unrivalled convenience of being able to plug in and play every one of their devices while you will benefit from the flexibility of being able to seamlessly upgrade to new entertainment technologies the moment they become available.



TOTAL POWER

There are few things more frustrating than arriving in a foreign country to find your devices' batteries are running low and cannot be recharged. With our TruGlobal Socket, such problems are a thing of the past.

TruGlobal Socket – The most compatible socket in the world

The patent-pending TruGlobal Socket accepts A, B, C, D, E, F, G, I, J, K and L plug types and is compatible with plugs used by virtually every traveler worldwide – the widest coverage ever in the history of sockets. It is also the first socket in its type and class to comply with IEC 60884-1:2002, BS546, BS1363-1, AS/NZS 3112 and SEV 1011 standards.

TOTAL ENTERTAINMENT

Entertainment has taken on a whole new meaning with the digital revolution. Photos and videos can be shared instantly; movies and music can be carried around effortlessly. People are in charge of what, when and how they are entertained. Ultimately, the Total Entertainment solution ensures that all kinds of devices and media carriers are usable and adds a new dimension to in-room entertainment.

HDMI port

As the latest standard for ultimate High Definition transmission, our HDMI port enables instant viewing of HD video on in-room TVs direct from video recorders. It also conforms to HDMI 1.3 specifications with deep color support.

USB2.0 port

With a high-speed 480Mbps-rated connection, this port enables mega-pixel digital photos to be shared in their full glory via in-room TVs without lag or delay.

RCA and S video socket

Compatible with all devices, this handy 4-socket enables guests to enjoy personal music and videos.

RELIABILITY HAS NEVER BEEN SO BEAUTIFUL

Extra-low-voltage control wallplates incorporating built-in RJ45 sockets are another area where ULTI sensuality can help your hotel set new benchmarks for simplicity and style. The ULTI ELV+ range of extra-low-voltage control wallplates is fully compatible with all state-of-the-art, centralized control systems in hotel guest rooms. There is no easier way to resolve long-standing reliability issues caused by compatibility problems between data cables and conventional 240V terminals. In addition to more reliable performance and a significant reduction of data losses, ULTI ELV+ will further add to your bottom line by measurably cutting installation times. Easily combinable with other switches, sockets and accessories in the ULTI range, ULTI ELV+ is the only currently available hotel management system connection, which won't compromise your guest rooms with sockets in different designs.

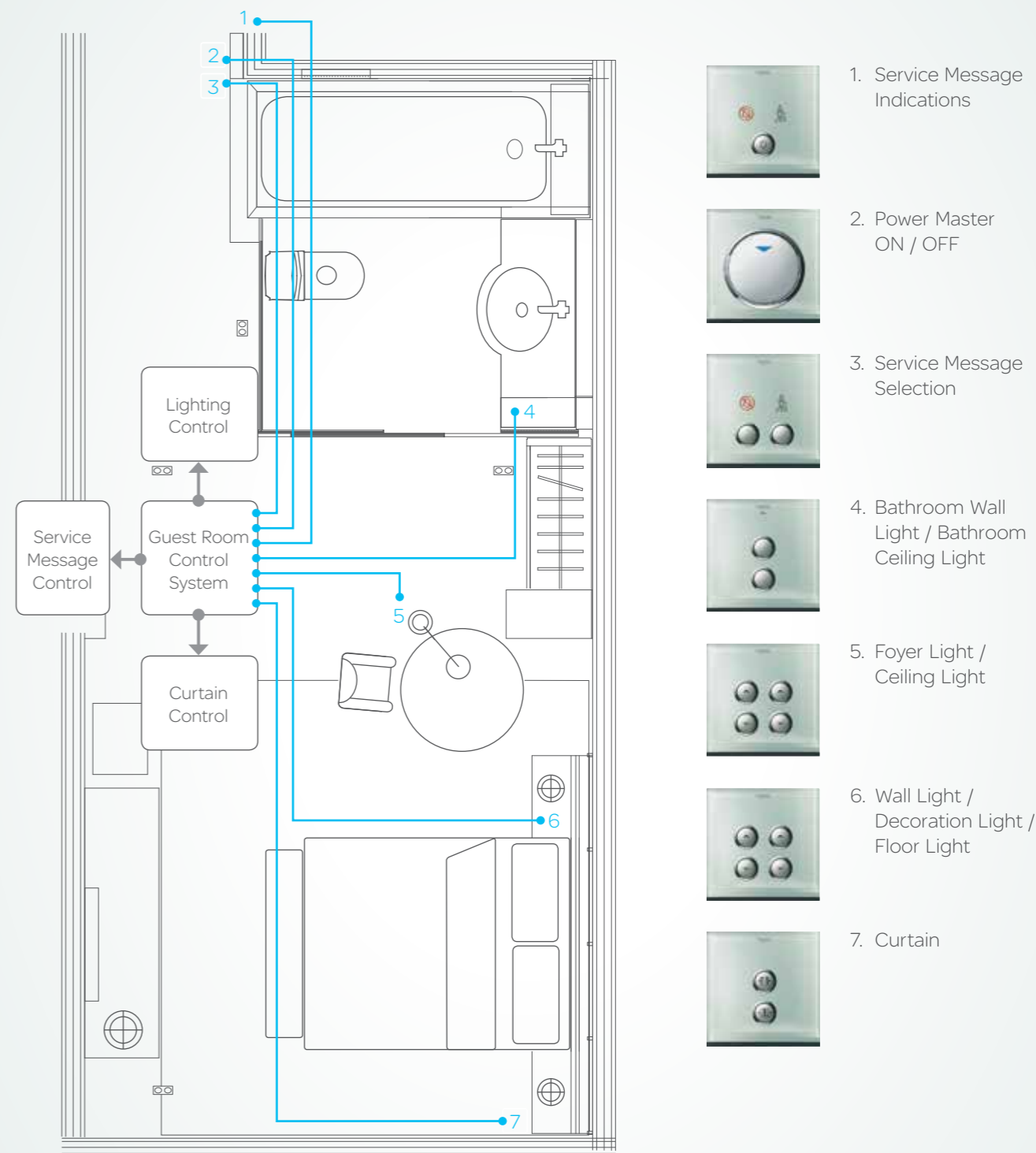
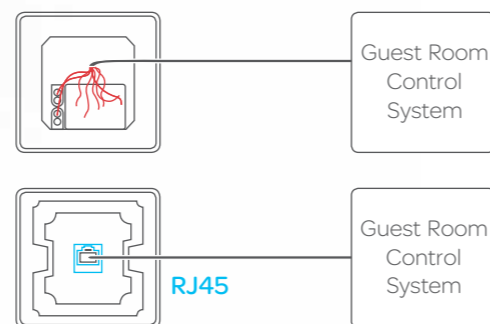

ULTI ARCHITECTURE

Interoperable

ULTI EZinstall 3

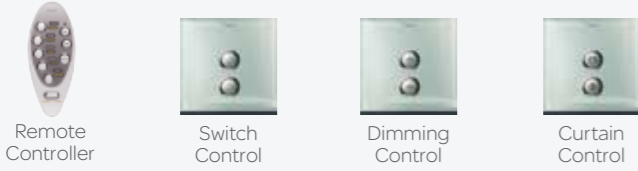

ULTI C-Bus Wired



Mini Home Control

ULTI EZinstall 3

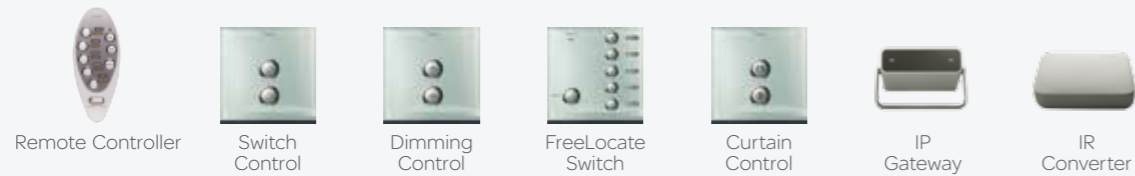

Electro-Mechanical

ULTI i.m.press

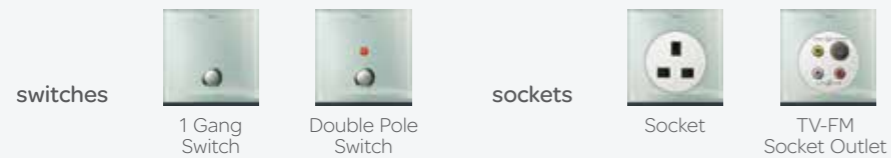

Extra-Low-Voltage

ULTI ELV+



ZigBee wireless

Back-end System

Wiser Home Control



Security System



Interoperable across all systems

C-Bus System - Lighting Control & Home Entertainment



Xightor video door phone touch screen

Any Hotel Management System

ULTI PRODUCT SPECIFICATIONS

Mechanical switches and sockets



Switch

- 110V 1 / 2 / 4 Gang 2 Way 16AX "i.m.press" Switch
- 250V 1 / 2 / 4 Gang 1 Way 16AX "i.m.press" Switch
- 250V 1 / 2 / 4 Gang 2 Way 16AX "i.m.press" Switch
- 250V 1 Gang 4A Bell Press Switch
- 250V 1 Gang 20A "i.m.press" Double Pole Switch with Pilot Light

A-Format Switches

- 1 / 2 / 4 Gang 1 Way 16AX "i.m.press" Switch
- 1 / 2 Gang 2 Way 16AX "i.m.press" Switch

Other

- 1 Gang Blank Plate

Socket

- 110V 1 Gang 15A 3 pin Socket
- 250V 1 Gang 13A BS Socket
- 250V Twin Gang 13A BS Socket
- 250V 1 Gang 13A Switched BS Socket
- 250V Twin Gang 13A Switched BS Socket
- 250V 1 Gang 2 pin 10A Socket
- 250V 1 Gang 2 x 2 pin 10A Socket
- 250V 1 Gang 2 / 3 pin 10A Socket
- 250V 1 Gang 3 pin 10A Socket
- 250V 1 Gang 3 pin 16A Socket
- 250V 1 Gang 6A 3 pin Universal Switched Socket
- 250V 1 Gang 6-16A Switched Socket
- 250V 1 Gang 5A Switched Socket
- 250V 1 Gang 15A Switched Socket
- 250V 1 Gang 16A Schuko Socket

Voice Data Information

- 1 Gang TV Socket
- 1 Gang F-Type TV Socket
- 1 Gang TV / FM Socket
- 1 Gang Telephone / Data Socket
- 2 Gang Telephone and Data Socket
- 1 Gang RCA / S-Video Socket



Colour Options

- Crystal Glass
- Pearl White
- Brushed Silver
- Champagne Gold

TruRetrofit mini home control



Switch

- 1 Gang 2000VA "EZinstall3" Switch
- 2 Gang 2 x 1000VA "EZinstall3" Switch
- 1 Gang 16A "EZinstall3" Double Pole Switch with Pilot Light
- 1 Gang 300VA "EZinstall3" Curtain Switch
- 2 Gang 2 x 300VA "EZinstall3" Curtain Switch

Dimmer

- 1 / 2 Gang 550W / 600W "EZinstall3" Dimmer
- 500v Plug Adapter Dimmer

FreeLocate Switch

- "EZinstall3" FreeLocate 2-Scene Switch
- "EZinstall3" FreeLocate 5-Scene Switch

Remote Controller

- "EZinstall3" Handheld Remote Controller

Other

- "EZinstall3" IR Converter
- "EZinstall3" IP Gateway
- "EZinstall3" 0-10V Dimmer Interface



Colour Options

- Crystal Glass
- Pearl White
- Brushed Silver
- Champagne Gold

Integrated automation



Input Unit

- 2 / 4 / 6 Button "C-Bus" Key Input
- 4 / 5 Button DLT Key Input
- Colour Touch Screen
- Black & White Touch Screen
- 5 Button eDLT Key Input



Colour Option

- White

HOTEL PRODUCT SPECIFICATIONS

Hotel accessories



Switch

1 / 2 / 4 Gang 12VDC Momentary Switch
Keycard Switch 220V

Socket

Universal Shaver Socket, 100/240VAC

ELV+

Keycard Switch 5V/12V
"Do Not Disturb / Please Clean Up" Control Switch-RJ45
"Do Not Disturb / Please Clean Up" Indicator with Bell Press-RJ45
Bedside Panel
1 / 2 / 4 Gang ELV Switch



Colour Options

Crystal Glass Pearl White
Brushed Silver Champagne Gold

EPIC Organiser

Face plate



2 Gang Panel



3 Gang Panel



4 Gang Panel



5 Gang Panel



Materials and finishes options

White Glass x Silver
Brushed Metal x Silver Pearl

Pick and mix modules

Total Power



TruGlobal Power Socket

Total Entertainment



USB and HDMI



RCA and S Video



RCA



USB



HDMI



VGA and Mini Audio

Other options



BS Power Socket



China 2-3 pin Power Socket



Keystone Voice & Data



Blank



Retractable Data Outlet



HDMI over UTP Transmission Socket



HDMI over UTP Transmission Socket

Plus plus plus



Grommet Plate



Cables & Conduits

Mounting options



False Wallmount

About Schneider Electric

As a global specialist in energy management with operations in more than 100 countries, Schneider Electric offers integrated solutions across multiple market segments, including leadership positions in energy and infrastructure, industrial processes, building automation, and data centres / networks, as well as a broad presence in residential applications. Focused on making energy safe, reliable, efficient, productive and green, the company's 150,000 plus employees achieved sales of 24 billion euros in 2013, through an active commitment to help individuals and organizations make the most of their energy.

www.schneider-electric.com

