

Item No	Material	尺寸									
		A(±0.30)	A1(±0.30)	B(±0.30)	B1(±0.20)	C(±0.30)					
CP52.5*47.2*25	PC44	52.50	45.00	47.20	5.60	25.00					
CP52.5*47.2*25	PC95	52.50	45.00	47.20	5.60	25.00					
CP50*46*25	PC44	50.00	46.00	46.00	5.00	25.00					
CP50*46*25	PC95	50.00	46.00	46.00	5.00	25.00					

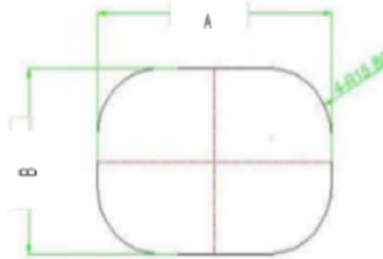
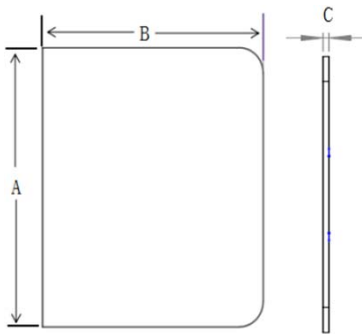

Item No	Material	尺寸									
		A(±0.30)	B(±0.30)	C(±0.30)							
CP55*46.4*25双拼	PC44	55.00	46.40	25.00							
CP55*46.4*25双拼	PC95	55.00	46.40	25.00							
CP61.55*41.55*25	PC44	61.55	41.55	25.00							
CP61.55*41.55*25	PC95	61.55	41.55	25.00							